

RESOLUTION NO. R-024-115

**THE BOARD OF COUNTY COMMISSIONERS
OF THE COUNTY OF DOUGLAS, COLORADO**

**A RESOLUTION APPROVING THE TEMPORARY ROAD CLOSURE OF
RIDGEGLEN WAY BETWEEN BURNTWOOD WAY AND BELLFLOWER WAY**

WHEREAS, Douglas County PW Engineering staff is requesting a ninety (90) day road closure for Ridgelen Way between Burntwood Way & Bellflower Way The closure will allow for the construction of the Douglas County Ridgelen Way 60" Storm Sewer Replacement Project, Douglas County Project Number SP2024-004; and

WHEREAS, Ridgelen Way is a County-maintained roadway; and

WHEREAS, the Board of County Commissioners (the "Board") has the authority to temporarily prohibit the operation of vehicles upon roads within its jurisdiction, pursuant to sections 42-4-106(1) and (6), C.R.S.; and

WHEREAS, the temporary road closure of Ridgelen Way will be needed for ninety (90) days between October 9, 2024 and ending on December 31, 2024; and

WHEREAS, Douglas County PW Engineering staff has prepared detour and signage plans for the closure of Ridgelen Way, access to Lily Ct, Conifer Ct and the single family residences will be maintained; now, therefore,

BE IT RESOLVED, by the **BOARD OF COUNTY COMMISSIONERS OF THE COUNTY OF DOUGLAS, STATE OF COLORADO**, hereby authorizes the approval of the temporary road closure of Ridgelen Way between Burntwood Way and Bellflower Way for a ninety (90) day road closure between October 9, 2024 and December 31, 2024.

BE IT FURTHER RESOLVED that a signed detour route with approved warning signs and barricades shall be erected at designated locations, as shown on the attached Exhibit A, prior to the temporary closure authorized herein.

BE IT FURTHER RESOLVED that such warning signs and barricades shall be removed and such road shall be reopened upon expiration of the temporary closure approved herein, or at such earlier time as determined by PW Engineering staff.

PASSED AND ADOPTED this 8th of **October 2024**, in Castle Rock, Douglas County, Colorado.

**THE BOARD OF COUNTY COMMISSIONERS
OF THE COUNTY OF DOUGLAS, COLORADO**

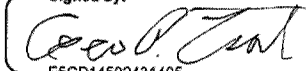
Signed by:

E5CD14592431405...

By: _____
George Teal, Chair

DocuSigned by:

166E3E33F00249B...

ATTEST: _____
Hayley Hall, Clerk to the Board

Signed by:

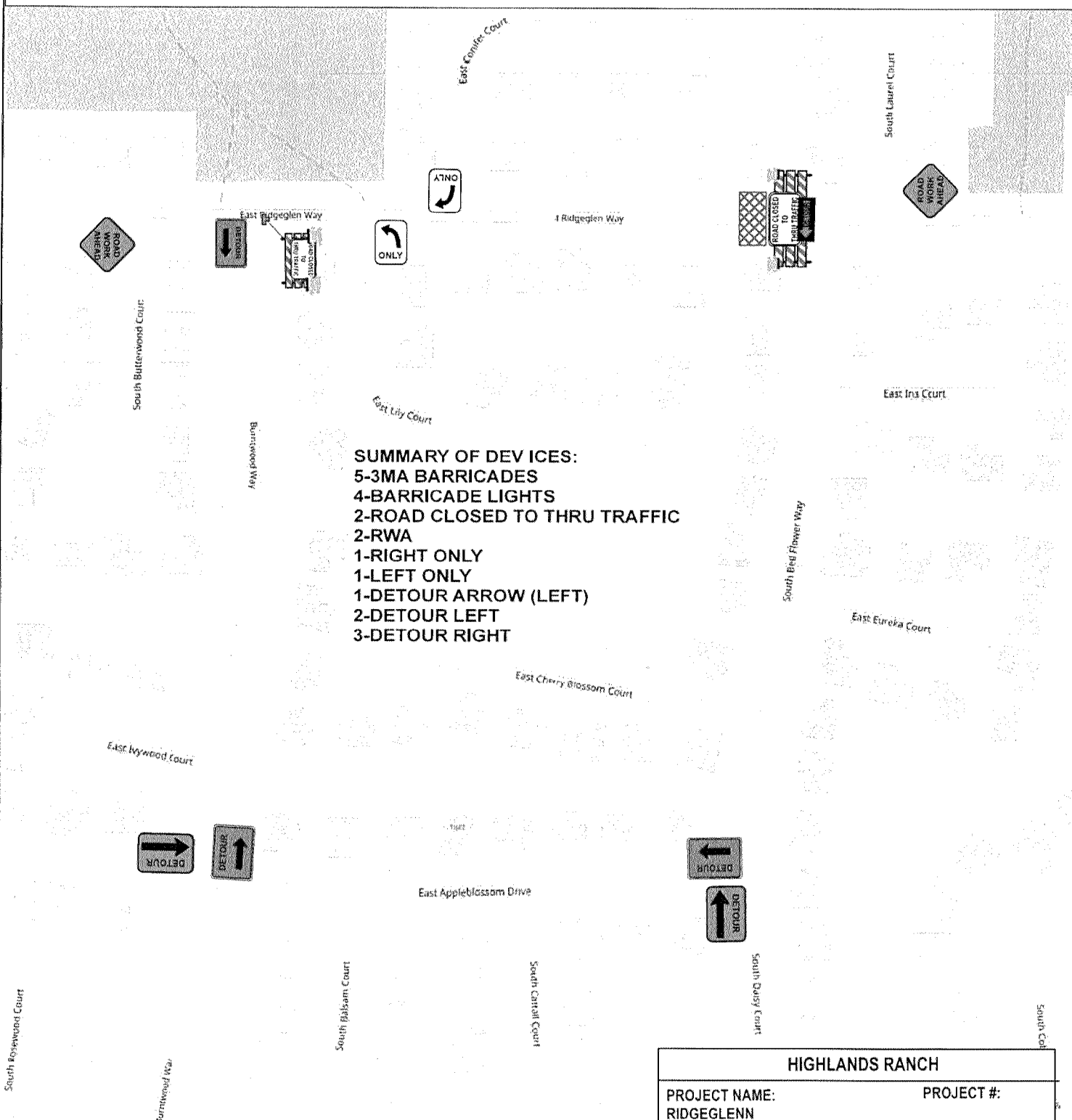
NOT TO SCALE



9945 TITAN PARK CIRCLE
 LITTLETON, CO 80126
 303-335-0915

ENTERPRISES, INC.
 TRAFFIC DIVISION

HIGHLANDS RANCH		
PROJECT NAME:	PROJECT #:	
RIDGEGLENN		
PRIME CONTRACTOR:	SUB CONTRACTOR:	
53 CORP		
PHONE:	MHT#: 1	DATE:
303-885-9634		9/11/24

NOT TO SCALE

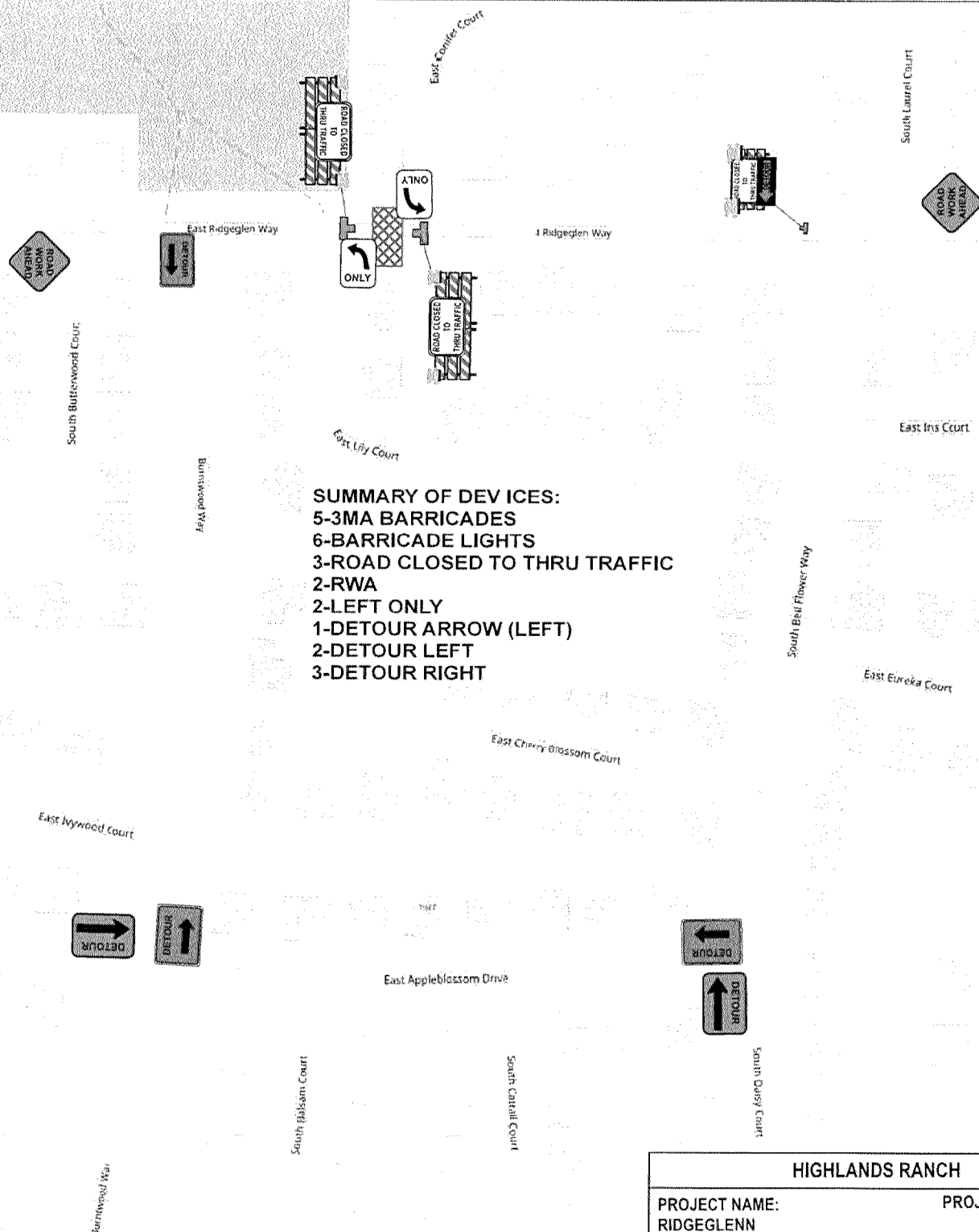

9945 TITAN PARK CIRCLE
 LITTLETON, CO 80126
 303-335-0915

ENTERPRISES, INC.
 TRAFFIC DIVISION

HIGHLANDS RANCH

PROJECT NAME:	PROJECT #:	
RIDGEGLENN		
PRIME CONTRACTOR:	SUB CONTRACTOR:	
53 CORP		
PHONE:	MHT#: 2	DATE:
303-885-9634		9/11/24

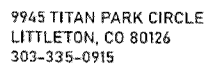

HIGHLANDS RANCH		
PROJECT NAME:	PROJECT #:	
RIDGEGLENN		
PRIME CONTRACTOR:	SUB CONTRACTOR:	
53 CORP		
PHONE:	MHT#: 3	DATE:
303-885-9634		9/11/24