

WILLIAM P. ANKELE, JR.
JENNIFER GRUBER TANAKA
CLINT C. WALDRON
KRISTIN BOWERS TOMPKINS
ROBERT G. ROGERS

OF COUNSEL:
KRISTEN D. BEAR
BLAIR M. DICKHONER



SEAN ALLEN
ZACHARY P. WHITE
CASEY K. LEKAHAL
TRISHA K. HARRIS
HEATHER L. HARTUNG
MEGAN J. MURPHY
EVE M. GRINA
JENNIFER F. KEMP
ALLISON C. FOGG

December 28, 2018

**VIA ELECTRONIC SUBMISSION
AND ELECTRONIC MAIL**

Division of Local Government

Douglas County Clerk & Recorder
recording@douglas.co.us

Douglas County Assessor
assessor@douglas.co.us

**Re: Maher Ranch Metropolitan District No. 4 (LGID#: 18092)
Map Filing Pursuant to §32-1-306, C.R.S. – No Change in Boundaries**

To Whom It May Concern:

Section 32-1-306, C.R.S., requires special districts to provide a current, accurate map of their boundaries to the Division of Local Government (the “Division”), County Clerk and Recorder and County Assessor by January 1 of each year. This letter is to inform you that the map that is currently on file with your office for the above-referenced District is the most current and accurate map. A copy of the current map is attached for your convenience.

Should you have any questions, please do not hesitate to contact me.

Sincerely,

WHITE BEAR ANKELE TANAKA & WALDRON
Attorneys at Law

Rose A. Vallesio
Paralegal

Attachment

District Map

LGID#: 18092

Mahe Ranch Metropolitan District #4 Authority # 4250

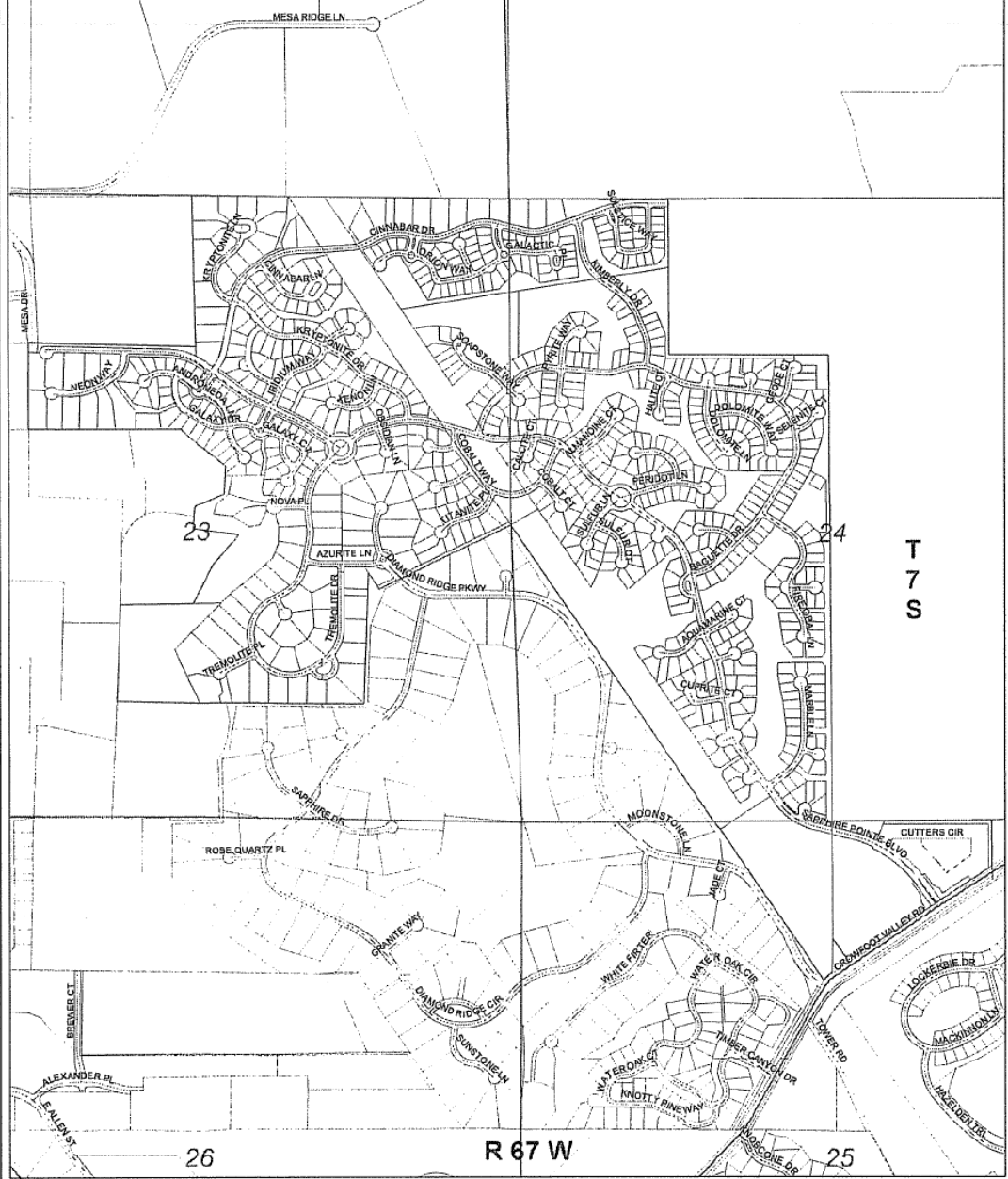
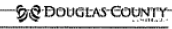

I, Blair Dickhoner, as representative of Mahe Ranch MD No. 4 District, do hereby certify
 Name (printed) District name
 this map to be an accurate representation of the district's boundary as shown. Signed this 21st day of December, 2009.
Blair Dickhoner Signature bdickhoner@wbape.com Email
Attorney Title (308) 858-1800 Phone

DISCLAIMER
 All data and information ("Products") contained herein are for informational purposes only. Although Products are believed to be accurate at the time of printing, Douglas County does not warrant that such Products are error-free. Douglas County provides these Products on an "as is" basis without representation of any kind, express or implied, including, but not limited to, accuracy, completeness, or suitability for any purpose. No warranty is made as to the accuracy or completeness of any data or information contained herein. Douglas County shall not be liable for any direct, indirect, incidental, or consequential damages arising out of the use of such Products, or the inability to use such Products, or out of any breach of any warranty. The user acknowledges and agrees that the use of such Products is at the user's sole risk.

General questions about this or any other Douglas County GIS product, including map information, can be made by contacting the Douglas County GIS Director at 308-863-1418.

Douglas County GIS Division
 P.O. Box 10000, Rapid City, SD 57709-1000
 Copyright 2009 Douglas County, SD

Legend
 — Maher Ranch Metropolitan District #4
 — Parcels
 — Sections
 — Townships
 — Major Roads
 — Local Roads

Scale: 1:9,600
 1 inch equals 800 feet

Vicinity Map: Shows the location of the district within the state of South Dakota.