

WILLIAM P. ANKELE, JR.
JENNIFER GRUBER TANAKA
CLINT C. WALDRON
KRISTIN BOWERS TOMPKINS
ROBERT G. ROGERS

OF COUNSEL:
KRISTEN D. BEAR
BLAIR M. DICKHONER



SEAN ALLEN
ZACHARY P. WHITE
CASEY K. LEKAHAL
TRISHA K. HARRIS
HEATHER L. HARTUNG
MEGAN J. MURPHY
EVE M. GRINA
JENNIFER F. KEMP
ALLISON C. FOGG

December 19, 2018

**VIA ELECTRONIC SUBMISSION
AND ELECTRONIC MAIL**

Division of Local Government
via e-filing portal

Douglas County Clerk & Recorder
recording@douglas.co.us

Douglas County Assessor
assessors@douglas.co.us

**Re: The Canyons Metropolitan District No. 2 (LGID#:65040)
Map Filing Pursuant to §32-1-306, C.R.S. – No Change in Boundaries**

To Whom It May Concern:

Section 32-1-306, C.R.S., requires special districts to provide a current, accurate map of their boundaries to the Division of Local Government, County Clerk and Recorder and County Assessor by January 1 of each year. This letter is to inform you that the map that is currently on file with your office for the above-referenced District is the most current and accurate map. A copy of the current map is attached for your convenience.

Should you have any questions, please do not hesitate to contact me.

Sincerely,

WHITE BEAR ANKELE TANAKA & WALDRON
Attorneys at Law

Paralegal

Attachment

EXHIBIT

THE CANYONS METROPOLITAN DISTRICT NO.2
PORTIONS OF SECTIONS 1, 2, 3, 10, 11, 12, 14 AND 15,
TOWNSHIP 7 SOUTH, RANGE 67 WEST OF THE 6TH P.M.,
DOUGLAS COUNTY, COLORADO

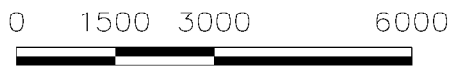
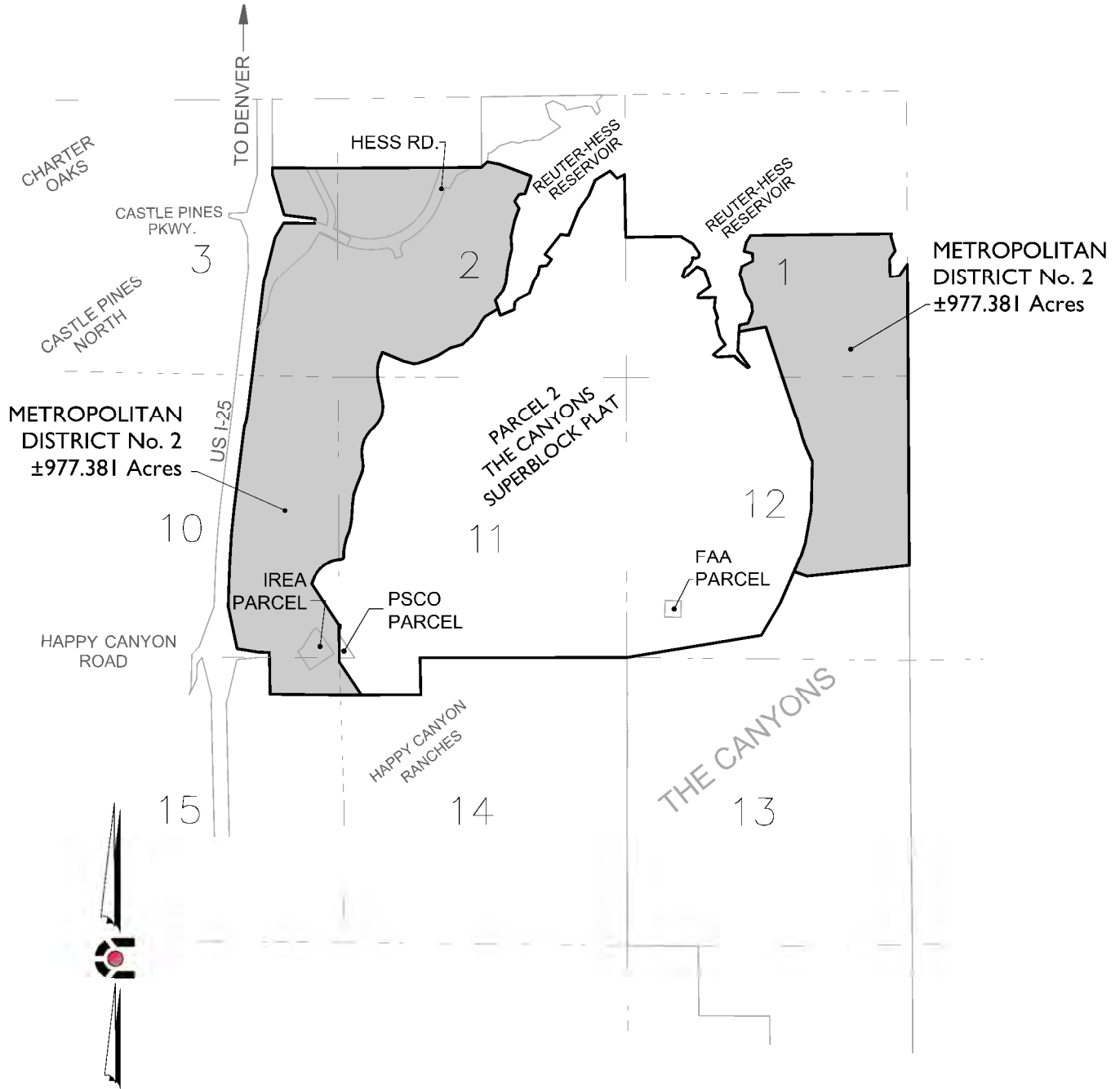

SCALE: 1" = 3000'

NOTE: THIS DOES NOT REPRESENT A MONUMENTED SURVEY.
IT IS INTENDED ONLY TO DEPICT THE ATTACHED DESCRIPTION.
PROJECT: 14-002 DR: J. ANTON
DATE: 12/24/15 DS: T. GIRARD
SHEET 1 OF 2 P.M. B. CALVERT



CORE
CONSULTANTS

CIVIL ENGINEERING
DEVELOPMENT CONSULTING
NATURAL RESOURCES
LAND SURVEYING
303.703.4444
1950 W. Littleton Blvd., Ste. 109
Littleton, CO 80120