

GARY R. WHITE
 KRISTEN D. BEAR
 WILLIAM P. ANKELE, JR.
 JENNIFER GRUBER TANAKA
 CLINT C. WALDRON
 KRISTIN BOWERS TOMPKINS
 ROBERT G. ROGERS

OF COUNSEL:
 BLAIR M. DICKHONER



SEAN ALLEN
 ZACHARY P. WHITE
 CASEY K. LEKAHAL
 TRISHA K. HARRIS
 HEATHER L. HARTUNG
 MEGAN J. MURPHY
 KRISTIN J. SCHLEDORN
 SILVIA FEJKA
 JOHN R. SHERMAN
 BRAD NEIMAN

December 27, 2017

**VIA ELECTRONIC SUBMISSION
 AND ELECTRONIC MAIL**

Division of Local Government
E-filed via www.dola.colorado.gov/e-filing

Douglas County Clerk & Recorder
recording@douglas.co.us

Douglas County Assessor
assessors@douglas.co.us

**Re: The Canyons Metropolitan District No. 7 (LGID#: 66227)
 Map Filing Pursuant to §32-1-306, C.R.S. – No Change in Boundaries**

To Whom It May Concern:

Section 32-1-306, C.R.S., requires special districts to provide a current, accurate map of their boundaries to the Division of Local Government, County Clerk and Recorder and County Assessor by January 1 of each year. This letter is to inform you that the map that is currently on file with your office for the above-referenced District is the most current and accurate map. A copy of the current map is attached for your convenience.

Should you have any questions, please do not hesitate to contact me.

Sincerely,

WHITE BEAR ANKELE TANAKA & WALDRON
 Attorneys at Law

Hayley M. Budzinski, Paralegal

Attachment

EXHIBIT

THE CANYONS METROPOLITAN DISTRICT NO. 7

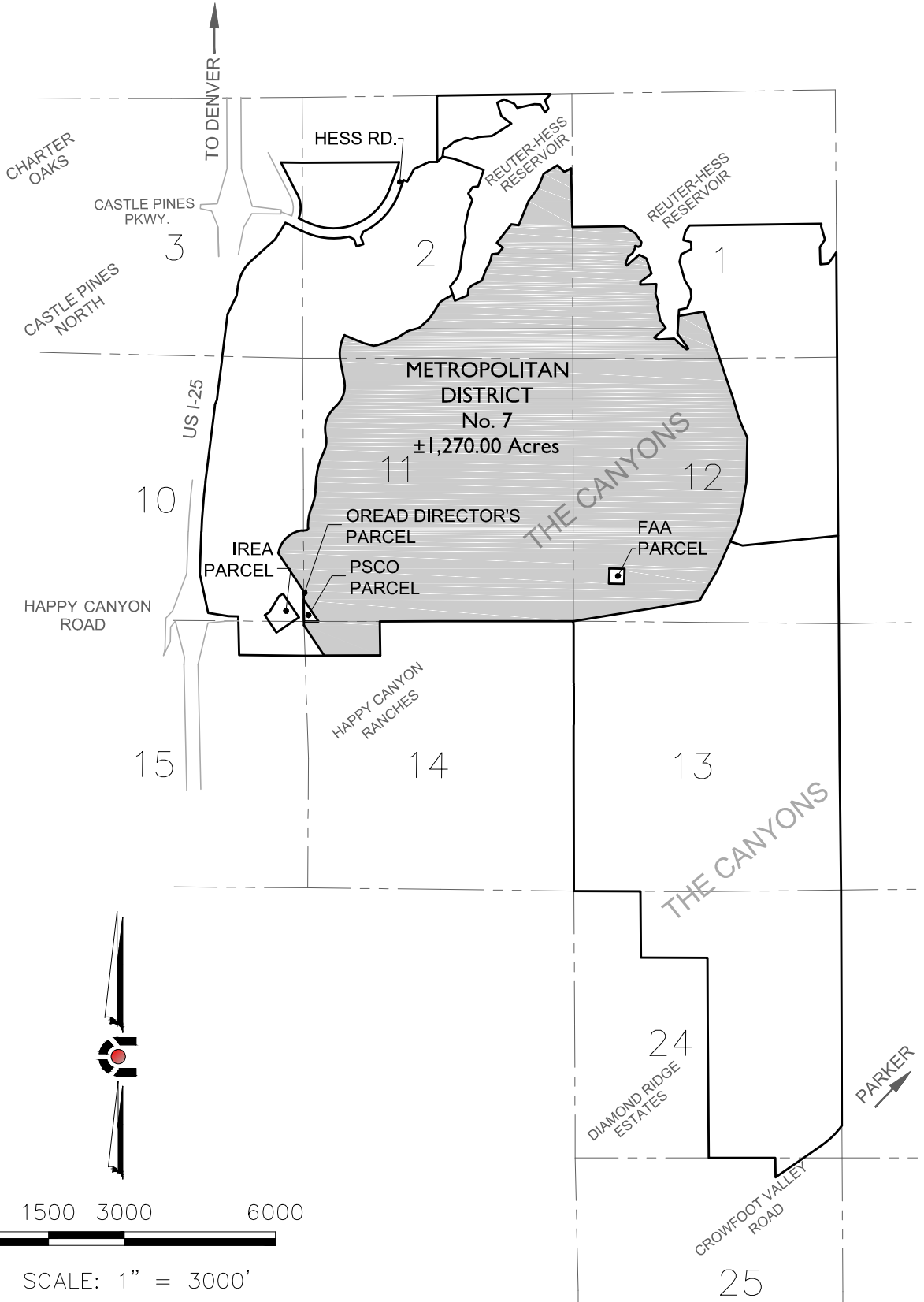

0 1500 3000 6000

SCALE: 1" = 3000'

NOTE: THIS DOES NOT REPRESENT A MONUMENTED SURVEY.
 IT IS INTENDED ONLY TO DEPICT THE ATTACHED DESCRIPTION.
 PROJECT: 14-002
 DATE: 12/16/15
 SHEET 3 OF 3

DR: J. ANTON
 DS: T. GIRARD
 P.M. B. CALVERT



CORE
 CONSULTANTS

CIVIL ENGINEERING
 DEVELOPMENT CONSULTING
 NATURAL RESOURCES
 LAND SURVEYING
 303.703.4444
 1950 W. Littleton Blvd., Ste. 109
 Littleton, CO 80120