

RESOLUTION NO. R-017-036

**THE BOARD OF COUNTY COMMISSIONERS
OF THE COUNTY OF DOUGLAS, COLORADO**

**A RESOLUTION APPROVING THE TEMPORARY ROAD CLOSURE OF PERRY
PARK AVENUE BETWEEN SILVERHEELS DRIVE AND QUARTZ MOUNTAIN
DRIVE**

WHEREAS, Douglas County Engineering Division is requesting a temporary road closure for Perry Park Avenue between Silverheels Drive and Quartz Mountain Drive. The closure will allow for the emergency repair of a failing existing drainage culvert under Perry Park Avenue; and

WHEREAS, Perry Park Avenue is a County-maintained roadway; and

WHEREAS, the Board of County Commissioners (the "Board") has the authority to temporarily prohibit the operation of vehicles upon roads within its jurisdiction, pursuant to sections 42-4-106(1) and (6), C.R.S.; and

WHEREAS, the temporary road closure of Perry Park Avenue will be needed for a maximum of 5 days, between on April 26, 2017 and July 1, 2017, when weather allows the completion of the Project on five consecutive days; and

WHEREAS, the Douglas County Engineering Division will prepare a detour – signage plan prior to the closure of Perry Park Avenue, now, therefore,

BE IT RESOLVED, by the **BOARD OF COUNTY COMMISSIONERS OF THE COUNTY OF DOUGLAS, STATE OF COLORADO**, hereby authorizes the approval of the temporary road closure of Perry Park Avenue between Silverheels Drive and Quartz Mountain Drive for five (5) consecutive days between April 26, 2017 and July 1, 2017, when weather allows completion of the Project.

BE IT FURTHER RESOLVED that a signed detour route with approved warning signs and barricades shall be erected at designated locations, as shown on the attached Exhibit A, prior to the temporary closure authorized herein.

BE IT FURTHER RESOLVED that such warning signs and barricades shall be removed and such road shall be reopened upon expiration of the temporary closure approved herein, or at such earlier time as determined by Douglas County Engineering Division.

PASSED AND ADOPTED this 25th of April, 2017, in Castle Rock, Douglas County,
Colorado.

**THE BOARD OF COUNTY COMMISSIONERS
OF THE COUNTY OF DOUGLAS, COLORADO**

By: 
ROGER A. PARTRIDGE, Chair

ATTEST:

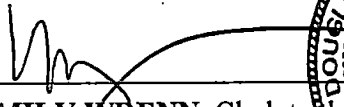
~~EMILY WRENN~~, Clerk to the Board

meghan mclann

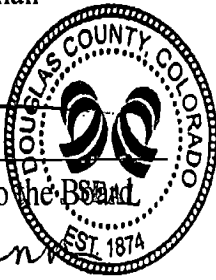

Road to be closed for 5 days during work week to replace culvert that crosses under road. A detour route will be set up that will be approximately 1.5 miles long. Traffic control devices will be in place for 24 hours a day until work is complete or at the end of the five day period. Dates are TBD

Work to be done by: Rocky Mountain Excavating

Emergency: 720-245-3885

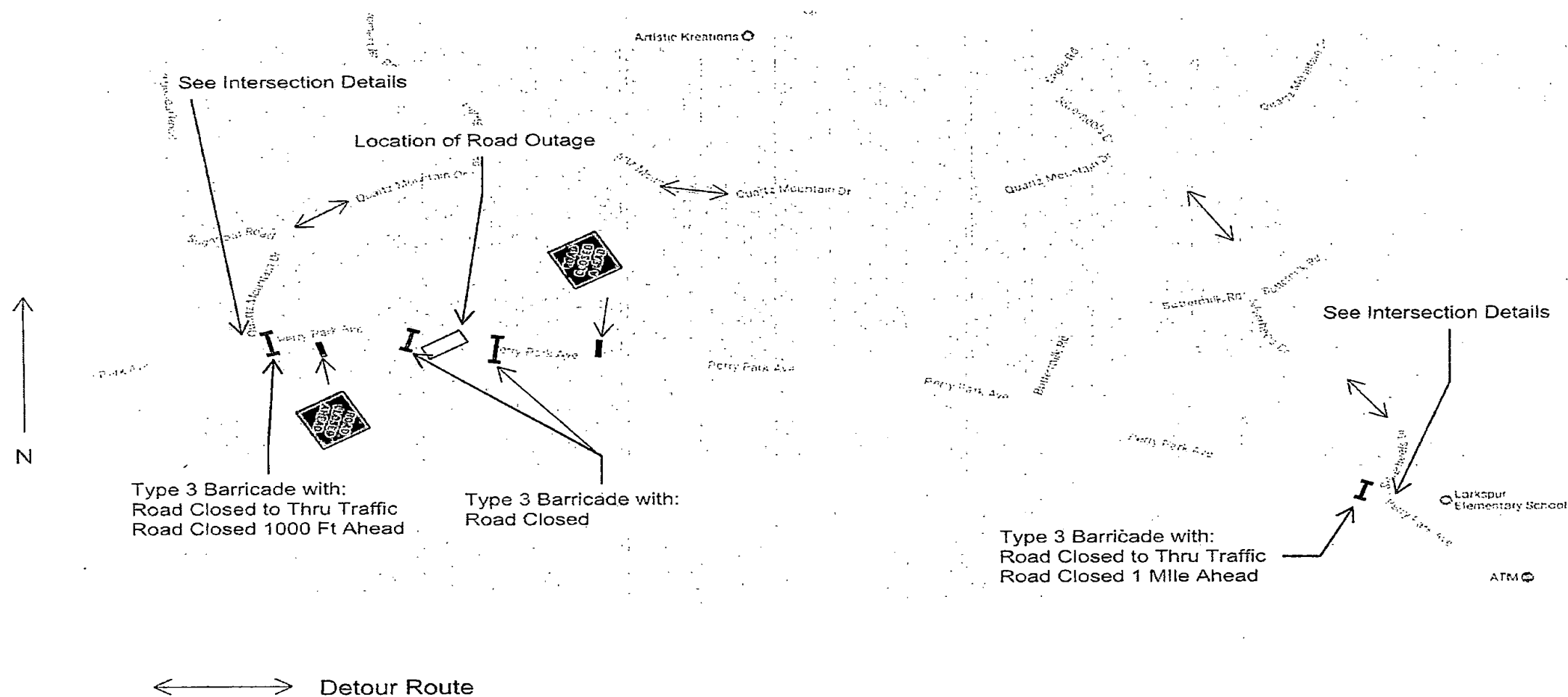

Intersection Details for Perry Park Ave. and Silverheels Dr.

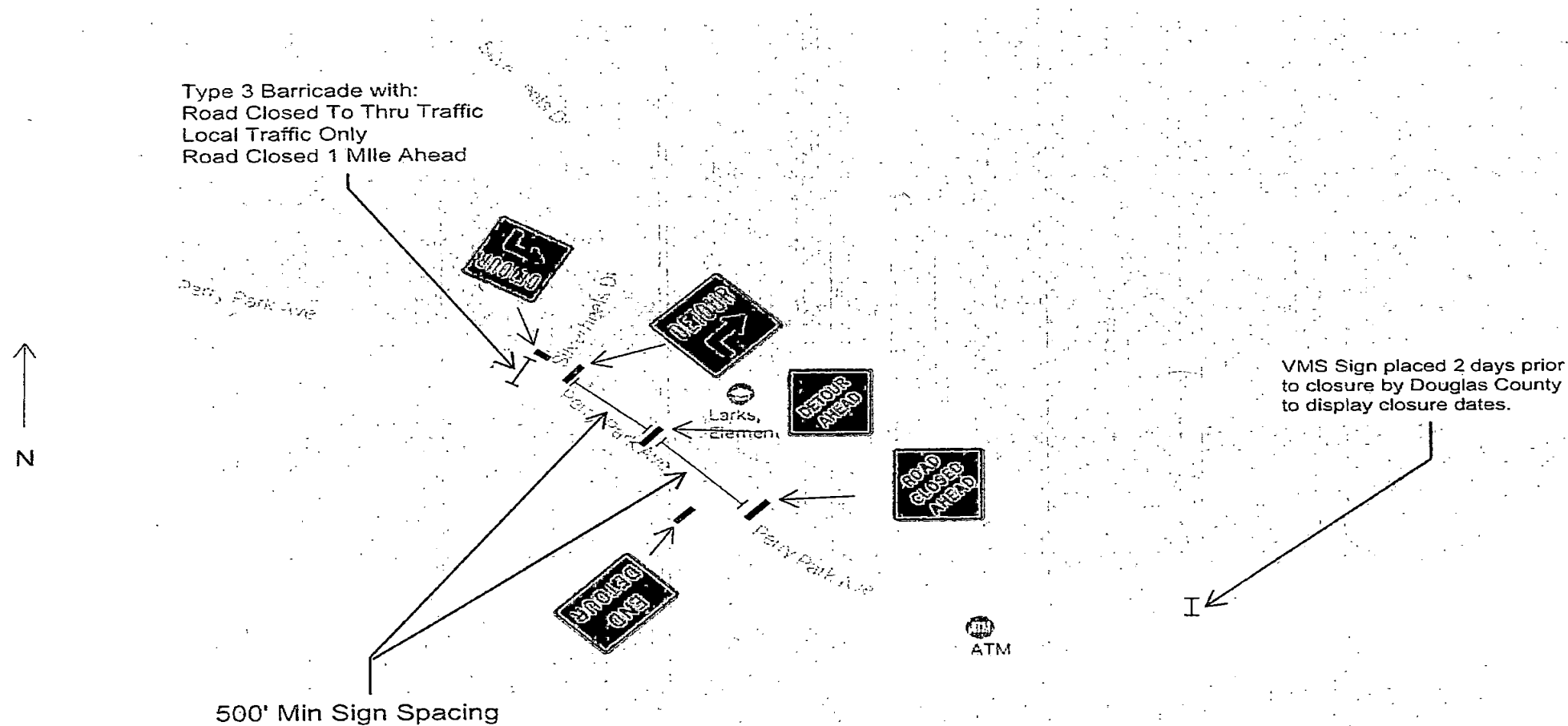

Intersection details for Perry Park Ave at Quartz Mountain Dr.

