

GARY R. WHITE
KRISTEN D. BEAR
WILLIAM P. ANKELE, JR.
JENNIFER GRUBER TANAKA
CLINT C. WALDRON
KRISTIN BOWERS TOMPKINS
ROBERT G. ROGERS

OF COUNSEL:
GEORGE M. ROWLEY
BLAIR M. DICKHONER



SEAN ALLEN
NEIL RUTLEDGE
ZACHARY P. WHITE
MEGAN L. TAGGART
CASEY K. LEKAHAL
TRISHA K. HARRIS
HEATHER L. HARTUNG
MEGAN J. MURPHY
AINSLEY E. BOCHNIAK
MARC D. SARMIENTO

December 21, 2016

**VIA ELECTRONIC SUBMISSION
AND ELECTRONIC MAIL**

Division of Local Government

Douglas County Clerk & Recorder
elections@douglas.co.us
recording@douglas.co.us

Douglas County Assessor
assessors@douglas.co.us

**Re: The Canyons Metropolitan District No. 7 (LGID#:66227)
Map Filing Pursuant to §32-1-306, C.R.S. – No Change in Boundaries**

To Whom It May Concern:

Section 32-1-306, C.R.S., requires special districts to provide a current, accurate map of their boundaries to the Division of Local Government, County Clerk and Recorder and County Assessor by January 1 of each year. This letter is to inform you that the map that is currently on file with your office for the above-referenced District is the most current and accurate map. A copy of the current map is attached for your convenience.

Should you have any questions, please do not hesitate to contact me.

Sincerely,

WHITE BEAR ANKELE TANAKA & WALDRON
Attorneys at Law

Ashley B. Frisbie
Paralegal

Attachment

EXHIBIT

THE CANYONS METROPOLITAN DISTRICT NO. 7

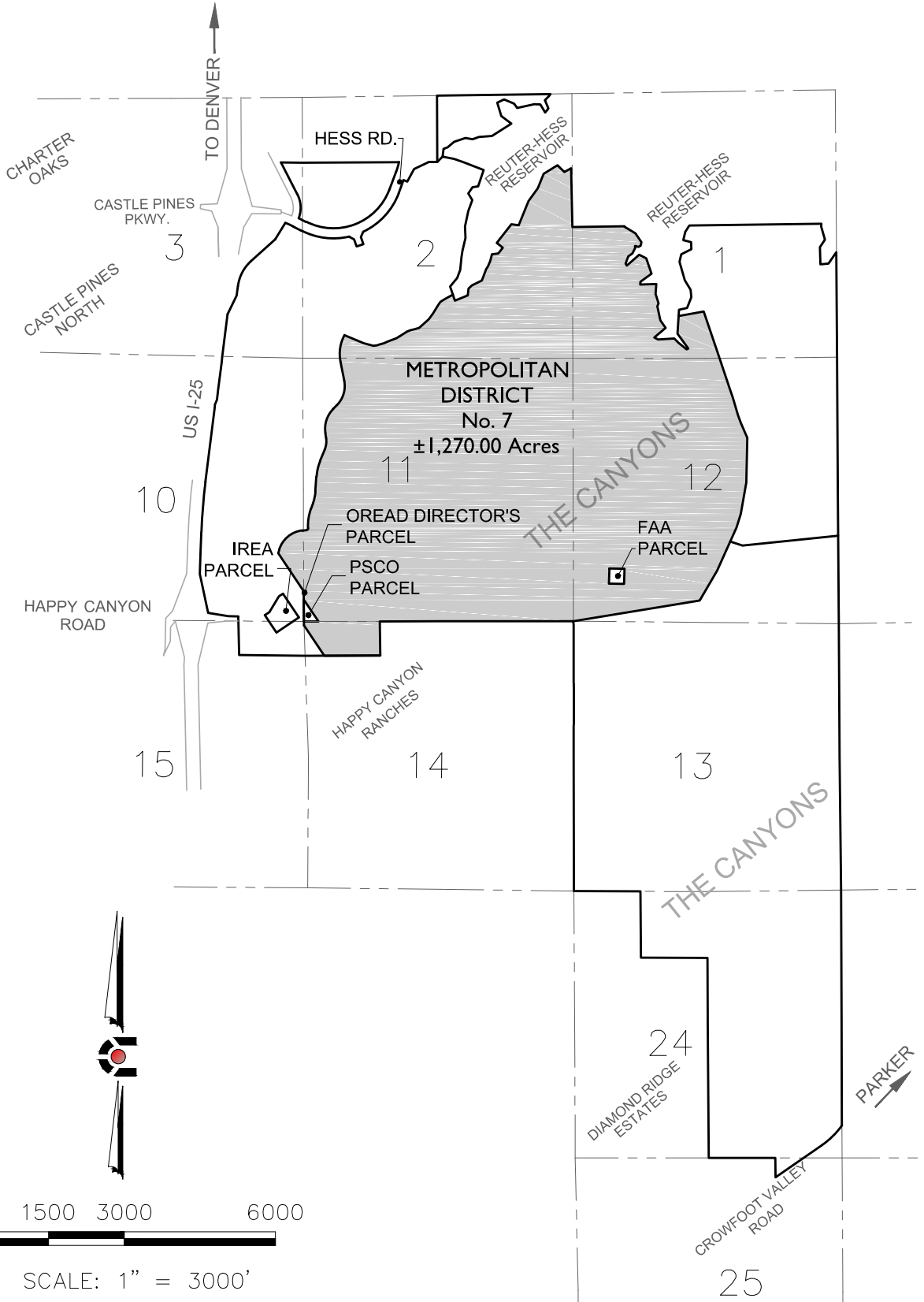

NOTE: THIS DOES NOT REPRESENT A MONUMENTED SURVEY.
 IT IS INTENDED ONLY TO DEPICT THE ATTACHED DESCRIPTION.
 PROJECT: 14-002
 DATE: 12/16/15
 SHEET 3 OF 3

DR: J. ANTON
 DS: T. GIRARD
 P.M. B. CALVERT



CORE
CONSULTANTS

**CIVIL ENGINEERING
 DEVELOPMENT CONSULTING
 NATURAL RESOURCES
 LAND SURVEYING**
 303.703.4444
 1950 W. Littleton Blvd., Ste. 109
 Littleton, CO 80120