

GARY R. WHITE
KRISTEN D. BEAR
WILLIAM P. ANKELE, JR.
JENNIFER GRUBER TANAKA
CLINT C. WALDRON
KRISTIN BOWERS TOMPKINS
ROBERT G. ROGERS

OF COUNSEL:
GEORGE M. ROWLEY
BLAIR M. DICKHONER



SEAN ALLEN
NEIL RUTLEDGE
ZACHARY P. WHITE
MEGAN L. TAGGART
CASEY K. LEKAHAL
TRISHA K. HARRIS
HEATHER L. HARTUNG
MEGAN J. MURPHY
AINSLEY E. BOCHNIAK
MARC D. SARMIENTO

December 20, 2016

VIA ELECTRONIC SUBMISSION
AND ELECTRONIC MAIL

Division of Local Government
E-filed via www.dola.colorado.gov/e-filing

Douglas County Clerk & Recorder
recording@douglas.co.us
elections@douglas.co.us

Douglas County Assessor
assessors@douglas.co.us

Re: Kings Point South Metropolitan District No. 1 (LGID#: 65122)
Map Filing Pursuant to §32-1-306, C.R.S. - No Change in Boundaries

To Whom It May Concern:

Section 32-1-306, C.R.S., requires special districts to provide a current, accurate map of their boundaries to the Division of Local Government, County Clerk and Recorder and County Assessor by January 1 of each year. This letter is to inform you that the map that is currently on file with your office for the above-referenced District is the most current and accurate map. A copy of the current map is attached for your convenience. Should you have any questions, please do not hesitate to contact me.

Sincerely,

WHITE BEAR ANKELE TANAKA & WALDRON
Attorneys at Law

Allison L. Hanson
Paralegal



Attachment

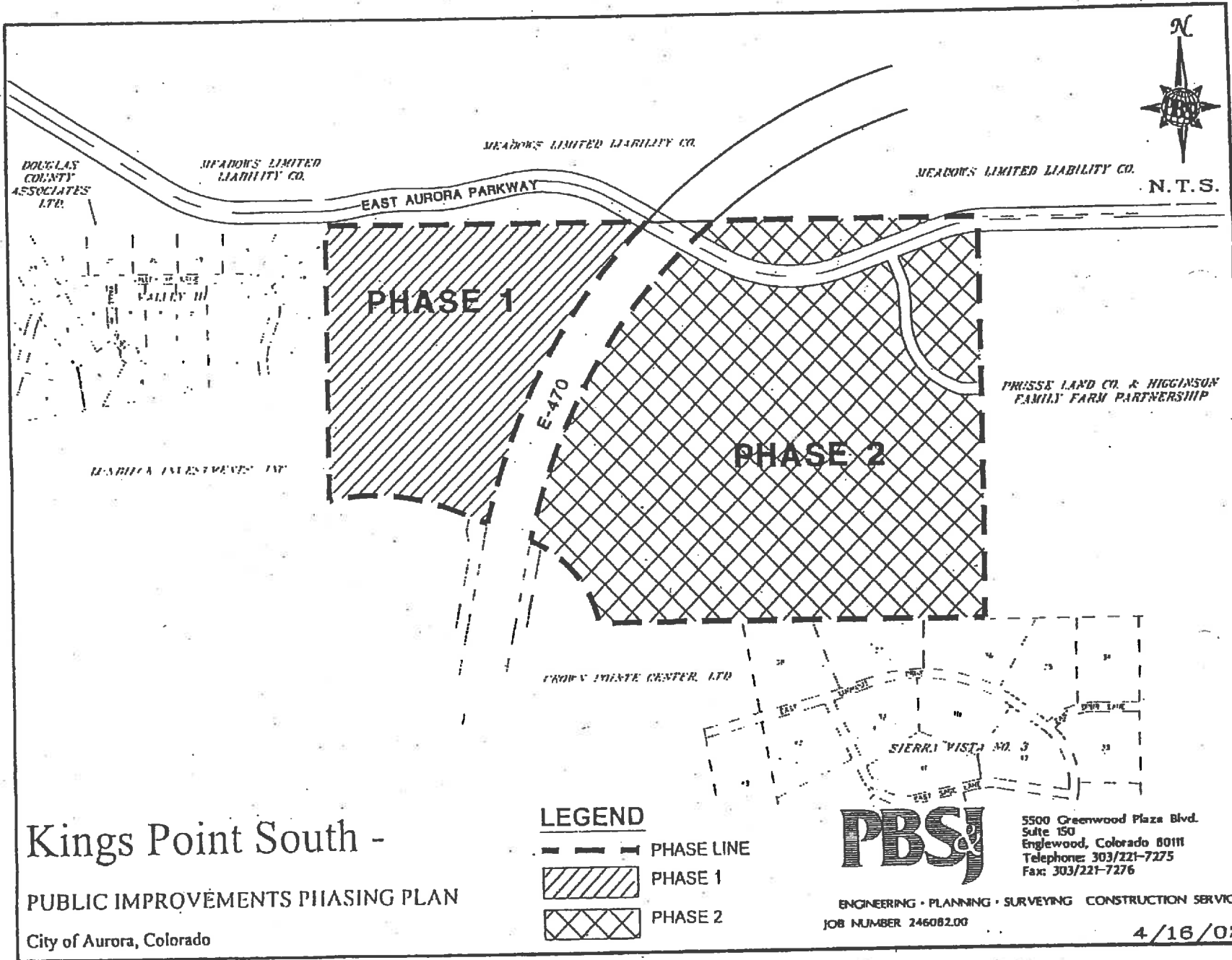

N.T.S.



Kings Point South -
PUBLIC IMPROVEMENTS PHASING PLAN
City of Aurora, Colorado

- LEGEND**
-  PHASE LINE
 -  PHASE 1
 -  PHASE 2



5500 Greenwood Plaza Blvd.
Suite 150
Englewood, Colorado 80111
Telephone: 303/221-7275
Fax: 303/221-7276

ENGINEERING • PLANNING • SURVEYING • CONSTRUCTION SERVICES
JOB NUMBER 246082.00

4/16/02