

GARY R. WHITE
KRISTEN D. BEAR
WILLIAM P. ANKELE, JR.
JENNIFER GRUBER TANAKA
CLINT C. WALDRON
KRISTIN BOWERS TOMPKINS
ROBERT G. ROGERS



SEAN ALLEN
GEORGE M. ROWLEY
NEIL RUTLEDGE
ZACHARY P. WHITE
MEGAN L. TAGGART
MATTHEW T. ASHLEY
CASEY K. LEKAHAL
TRISHA K. HARRIS

December 29, 2015

**VIA ELECTRONIC SUBMISSION
AND ELECTRONIC MAIL**

Division of Local Government

Douglas County Clerk & Recorder
recording@douglas.co.us
elections@douglas.co.us

Douglas County Assessor
assessors@douglas.co.us

**Re: Parker Automotive Metropolitan District (LGID#: 65257)
Map Filing Pursuant to §32-1-306, C.R.S. - No Change in Boundaries**

To Whom It May Concern:

Section 32-1-306, C.R.S., requires special districts to provide a current, accurate map of their boundaries to the Division of Local Government, County Clerk and Recorder and County Assessor by January 1 of each year. This letter is to inform you that the map that is currently on file with your office for the above-referenced District is the most current and accurate map. A copy of the current map is attached for your convenience.

Should you have any questions, please do not hesitate to contact me.

Sincerely,

WHITE BEAR ANKELE TANAKA & WALDRON
Attorneys at Law

Nadia R. Hernandez
Paralegal

Attachment

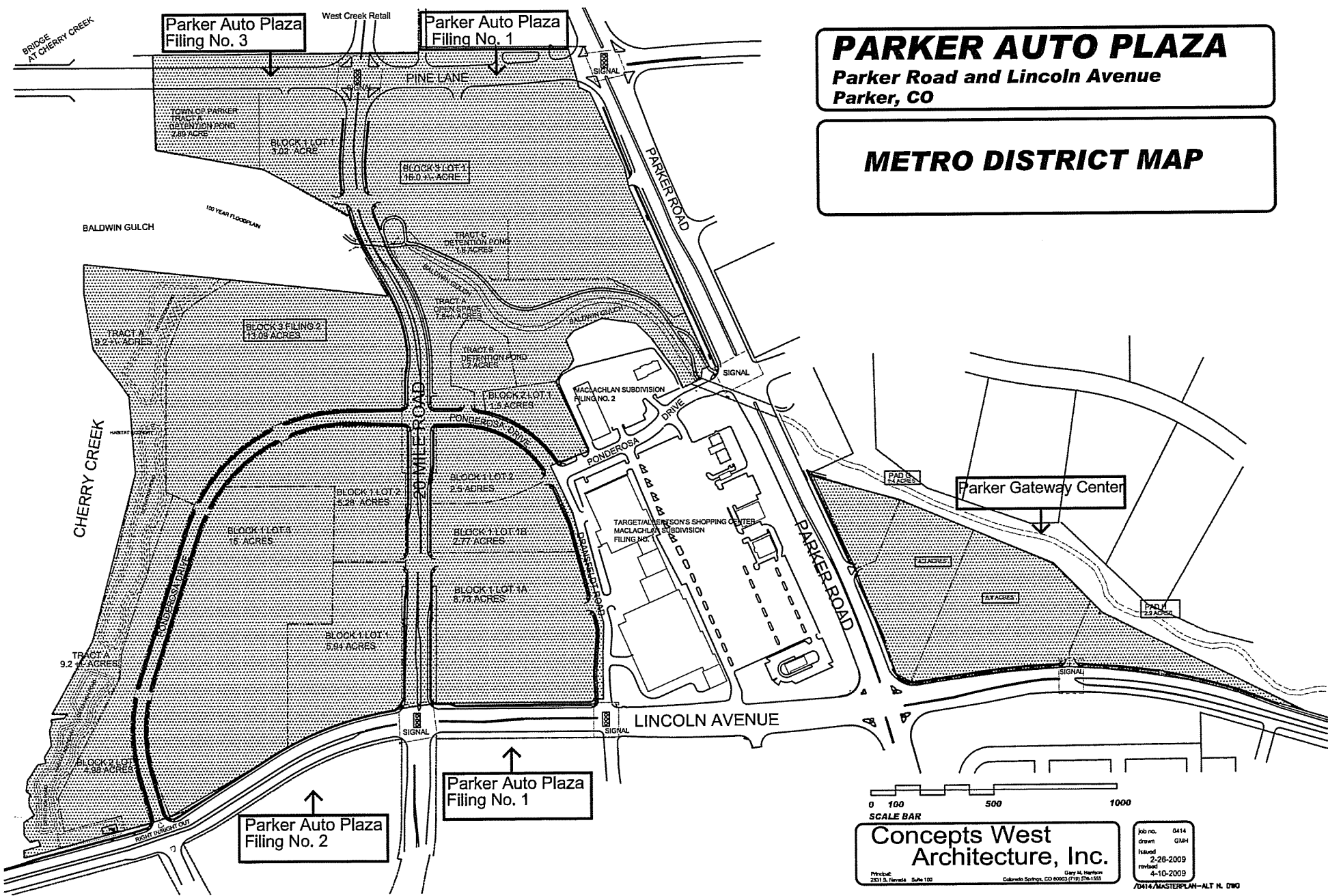

PARKER AUTO PLAZA
 Parker Road and Lincoln Avenue
 Parker, CO

METRO DISTRICT MAP

Parker Auto Plaza
 Filing No. 3

Parker Auto Plaza
 Filing No. 1

Parker Auto Plaza
 Filing No. 2

Parker Auto Plaza
 Filing No. 1

Parker Gateway Center

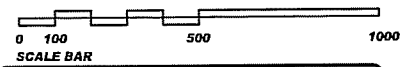

**Concepts West
 Architecture, Inc.**
 Principal: Gary M. Harbison
 2531 S. Nevada Suite 100 Colorado Springs, CO 80903 (719) 576-1553

Job no. 0414
 drawn G181
 issued 2-26-2009
 revised 4-10-2009