

**Castle Pines Commercial Metropolitan District No. 3**  
**8390 E Crescent Parkway, Suite 500**  
**Greenwood Village, Colorado 80111**  
**Office: 303.779.4525 Fax: 303.773.2050**

December 29, 2015

Division of Local Government  
1313 Sherman Street, Room 521  
Denver, CO 80203  
Via E-File Portal

Office of the Douglas County Assessor  
301 Wilcox Street  
Castle Rock, CO 80104  
assessors@douglas.co.us

Office of the County Clerk & Recorder  
301 Wilcox Street, 1<sup>st</sup> Floor  
Castle Rock, CO 80104  
recording@douglas.co.us

Re: Castle Pines Commercial Metropolitan District No. 3 – Map Filing

Dear Filing Administrator:

Colorado Revised Statute §32-1-306 requires special districts to provide a current, and accurate map of its boundaries to the Division of Local Government, County Assessor and Clerk and Recorder on or before January 1, of each year. In 2015 the District above has had boundary adjustments, inclusions, or exclusions. An updated boundary map is attached.

Should you have further questions or need additional information, please contact the undersigned via email or by telephone at (303) 779-4525.

Sincerely,

*Kathy Suazo*

Kathy Suazo  
District Administrator

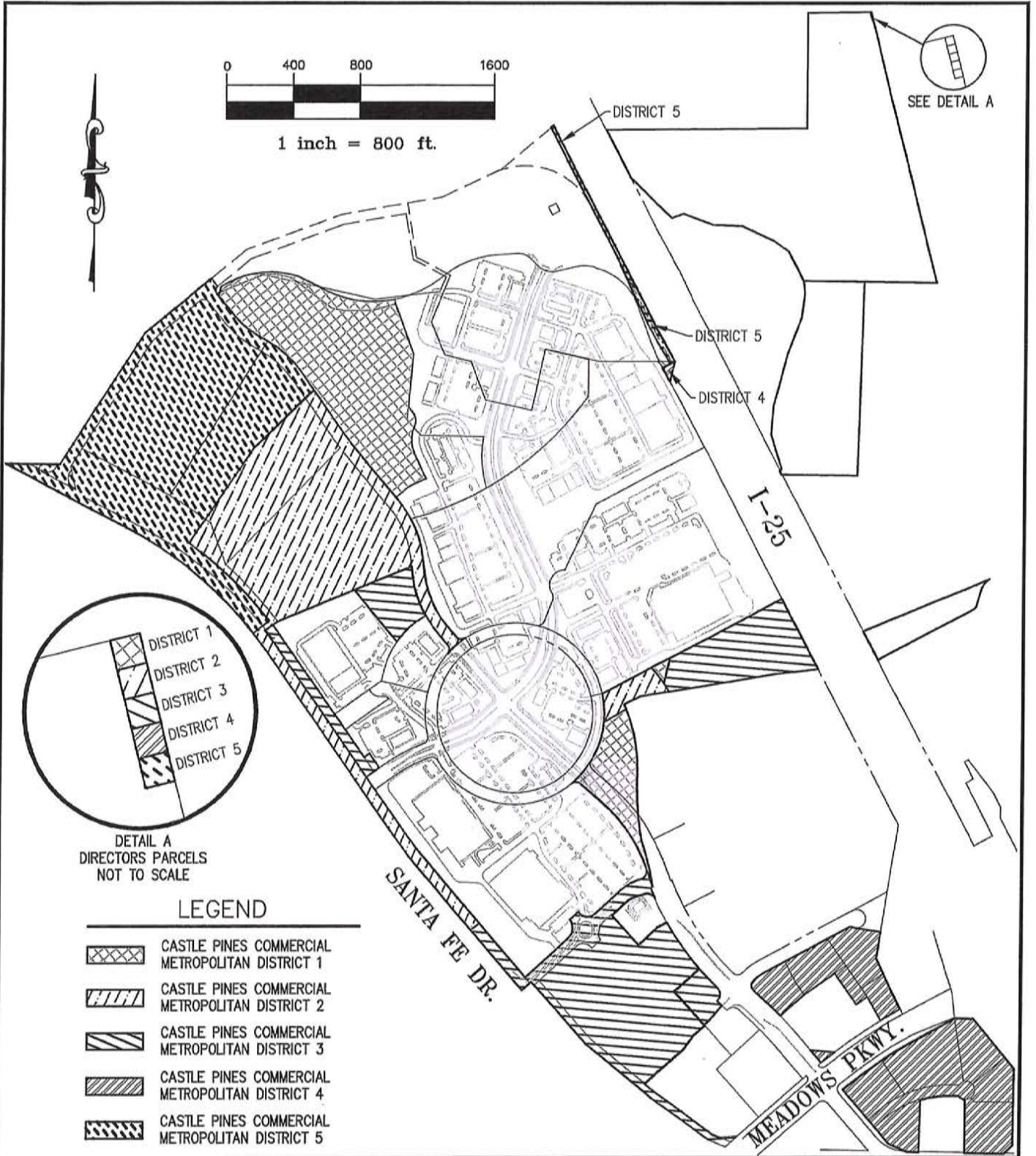

LAST REVISED 2014-12-24

**AZTEC**  
CONSULTANTS, INC.

300 East Mineral Ave,  
Suite 1  
Littleton, Colorado 80122  
Phone: (303)713-1898  
Fax: (303)713-1897  
www.aztecconsultants.com

JOB NUMBER: 93914-01

**DISTRICT MAP**  
CASTLE PINES COMMERCIAL METRO. DISTRICTS  
TOWN OF CASTLE ROCK, COLORADO

DATE: 2014-11-26

SHT 1 OF 1