

GARY R. WHITE  
KRISTEN D. BEAR  
WILLIAM P. ANKELE, JR.  
JENNIFER GRUBER TANAKA\*  
K. SEAN ALLEN  
GEORGE M. ROWLEY\*\*

**WHITE • BEAR • ANKELE**  
PROFESSIONAL CORPORATION  
ATTORNEYS AT LAW

CLINT C. WALDRON  
NEIL RUTLEDGE  
\*\*\*ROBERT G. ROGERS  
BRENT E. BUTZIN  
KRISTIN J. BOWERS  
\*\*\*\*ZACHARY P. WHITE

May 30, 2013

**VIA ELECTRONIC SUBMISSION  
AND ELECTRONIC MAIL:**

Division of Local Government  
1313 Sherman Street, Room 521  
Denver, Colorado 80203

**Re: Castleview Metropolitan District (LGID# 65799)  
2013 Map Filing**

Dear Sir or Madam,

Colorado Revised Statutes §32-1-306 requires special districts to provide a current, accurate map of their boundaries to the Division, Clerk and Recorder, and Assessor each year. This letter is to inform you that the map currently on file with your office for the above-referenced district is the most current and accurate map. A copy of the map is enclosed for your convenience.

If you have any questions please feel free to contact me.

Very truly yours,

WHITE, BEAR & ANKELE  
Professional Corporation

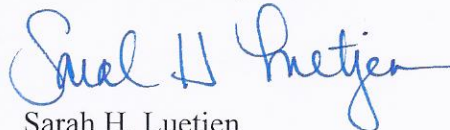

Sarah H. Luetjen  
Paralegal

Enclosure

cc: Douglas County Clerk & Recorder  
[recording@douglas.co.us](mailto:recording@douglas.co.us)

Douglas County Assessor  
[assessors@douglas.co.us](mailto:assessors@douglas.co.us)

0639.0024:510186

[www.whitebearankele.com](http://www.whitebearankele.com)  
2154 E. Commons Avenue, Suite 2000 • Centennial, CO 80122  
Telephone (303) 858-1800 • Facsimile (303) 858-1801  
Also licensed in \*New Mexico, \*\*Utah, \*\*\*Texas  
\*\*\*\*Colorado Admission Pending

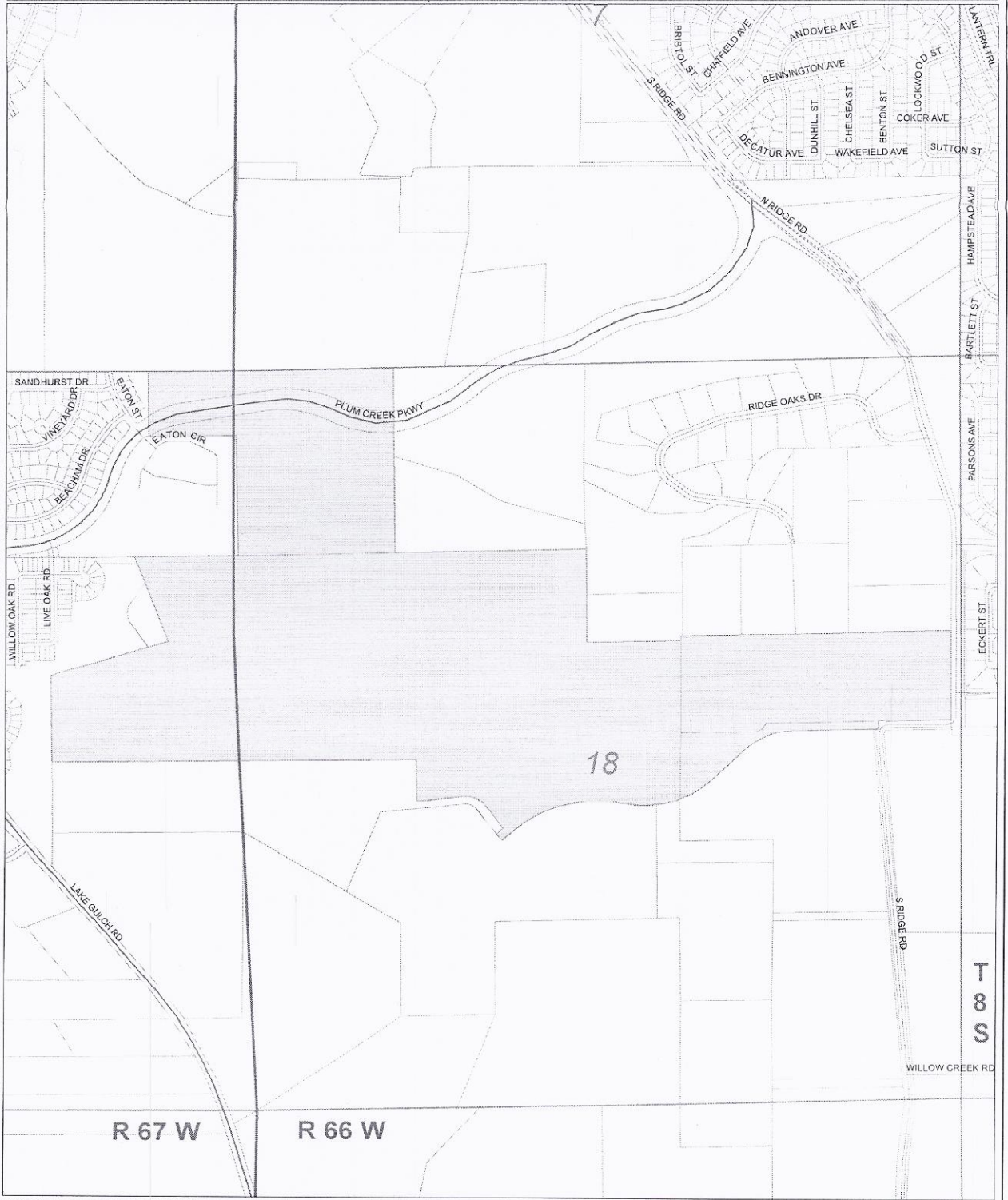

I, \_\_\_\_\_, as representative of \_\_\_\_\_ District, do hereby certify  
 Name (printed) District name  
 this map to be an accurate representation of the district's boundary as shown. Signed this \_\_\_\_\_ day of \_\_\_\_\_, 20\_\_\_\_.

Signature \_\_\_\_\_ Email \_\_\_\_\_  
 Title \_\_\_\_\_ Phone \_\_\_\_\_

DISCLAIMER

All area and boundary ("Products") contained herein are for informational purposes only. Although these Products are believed to be accurate as the best of planning, Douglas County does not warrant the accuracy of these Products. Douglas County provides these Products on an "as is" basis without warranties of any kind, express or implied, including, but not limited to, warranties of title or accuracy of information or fitness for a particular purpose. Douglas County shall not be liable for any direct, indirect, incidental, special or consequential damages arising out of the use of such Products, or the inability to use such Products or out of any breach of any warranty. The user acknowledges and agrees that the use of such Products is at the user's sole risk.

Copyright 2009 Douglas County GIS Division. All rights reserved. No part of this document may be reproduced or transmitted in any form or by any means electronic or mechanical, including photocopying, recording, or by any information storage and retrieval system, without permission in writing from Douglas County GIS Division at (303) 650-7436.

Douglas County GIS Division  
 Philip S. Miller (ESQ.), 300 First St.  
 Castle Rock, Colorado 80104

- Legend**
- Castleview Metropolitan District
  - Parcels
  - Sections
  - Townships
  - Major Roads
  - Local Roads

