

ICENOGLE | SEAVER | POGUE

A Professional Corporation

Attorneys at Law

4725 South Monaco Street, Suite 225

Denver, Colorado 80237

Telephone: 303.292.9100

Facsimile: 303.292.9101

STACIE L. PACHECO
SPacheco@ISP-law.com
Direct: 303.867.3000

December 19, 2013

Mr. Jack Arrowsmith
Douglas County Clerk and Recorder
P.O. Box 1360
Castle Rock, Colorado 80104

Re: Roxborough Water & Sanitation District

To Whom It May Concern:

As required by the Colorado Revised Statutes §32-1-306 special districts are required to file a current, accurate map of its boundaries with the Clerk and Recorder each year. Attached please find a copy of the most current boundary map of the District.

To confirm for our records that you have received this letter, please sign the enclosed acknowledgement and return it to our office in the enclosed, self-addressed, stamped envelope. Please contact our office with any questions regarding this matter.

Sincerely,

ICENOGLE | SEAVER | POGUE
A Professional Corporation



Stacie L. Pacheco
Paralegal

/SLP

Enclosure

ACKNOWLEDGEMENT

Received this 23rd day of December, 2013 from Icenogle Seaver Pogue, P.C., a letter concerning the District's boundaries is in compliance with Section 32-1-306, C.R.S., **Roxborough Water & Sanitation District.**

DOUGLAS COUNTY CLERK & RECORDER

By: Nancy Sotomayor
Printed Name: Nancy Sotomayor
Title: Recording Manager

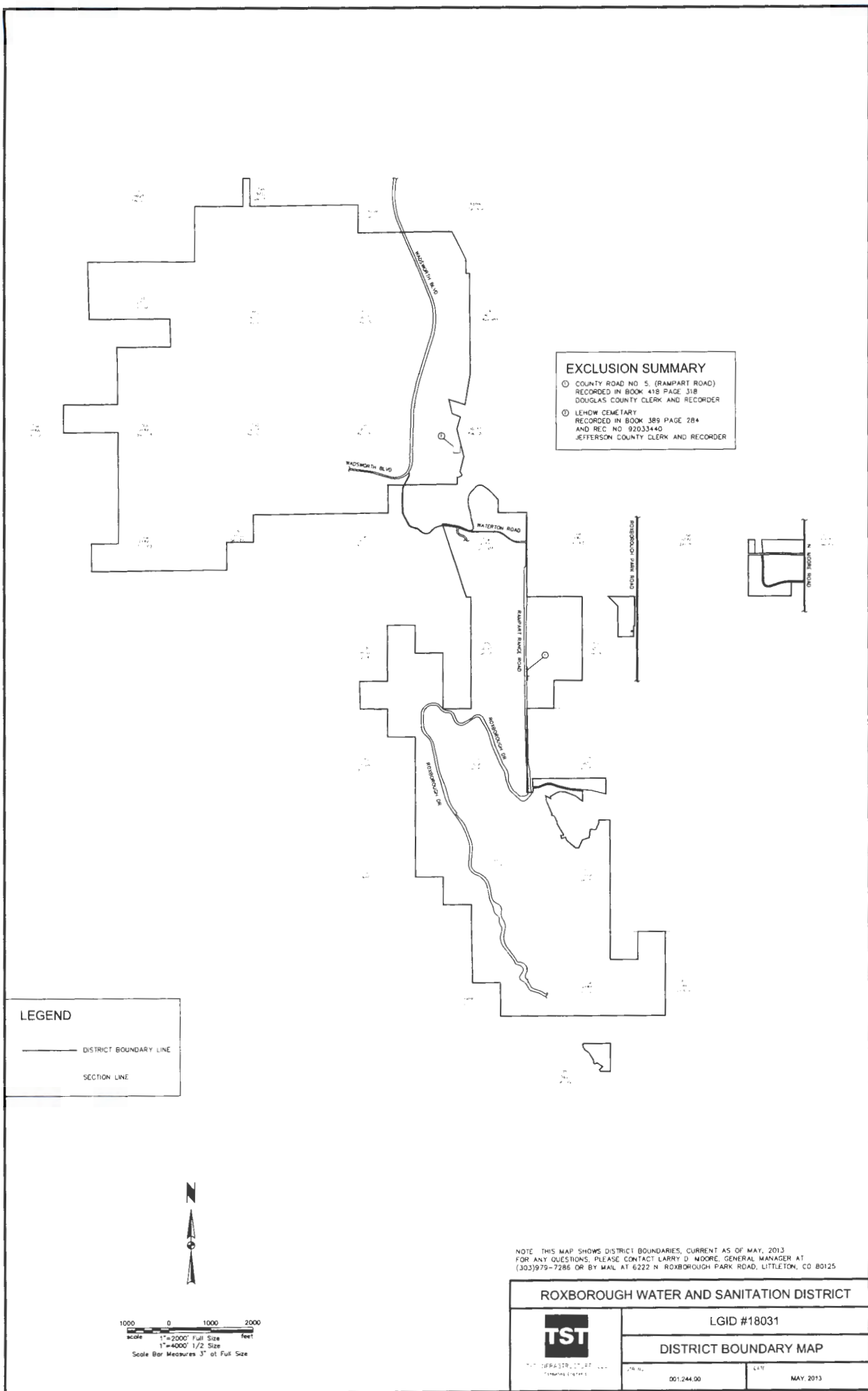

LAST UPDATE: 05/16/2013

ROXBOROUGH WATER AND SANITATION DISTRICT BOUNDARY

DISTRICT LEGAL DESCRIPTION:

THE ROXBOROUGH WATER AND SANITATION DISTRICT BOUNDARY INCLUDES NINE (9) SEPARATE PARCELS AS SHOWN ON THE ATTACHED EXHIBIT AND DESCRIBED AS FOLLOWS:

PARCEL 1 - ORIGINAL DISTRICT BOUNDARY (1972):

AS DESCRIBED IN THE ORGANIZATION OF ROXBOROUGH PARK METROPOLITAN DISTRICT PETITION DATED NOVEMBER 16, 1971 AND FILED AS BOOK 20, PAGE 23 IN THE OFFICE OF THE DOUGLAS COUNTY CLERK AND RECORDER.

THE FOLLOWING DESCRIBED REAL PROPERTY SITUATE, LYING AND BEING IN THE COUNTY OF DOUGLAS, STATE OF COLORADO:

A.) TOWNSHIP 6 SOUTH, RANGE 69 WEST OF THE 6TH P.M.
THE SOUTH 1/2 OF THE SE 1/4 OF SECTION 35.

B.) TOWNSHIP 7 SOUTH, RANGE 68 WEST OF THE 6TH P.M.
THE WEST 1/2 OF THE NW 1/4 AND THE NW 1/4 OF THE SW 1/4 OF SECTION 19.

THE FOLLOWING FALL WITHIN TOWNSHIP 7 SOUTH, RANGE 69 WEST OF THE 6TH P.M.

C.) THE NW 1/4 OF SECTION 1.

D.) THE NE 1/4; THE WEST 1/2 OF THE SW 1/4 AND THE SE 1/4 OF SECTION 2.

E.) THE SE 1/4 OF THE NE 1/4 AND THE NE 1/4 OF THE SE 1/4 OF SECTION 3.

F.) THE NE 1/4 OF THE NE 1/4 OF SECTION 10.

G.) SECTION 11 ALL-INCLUSIVE.

H.) THE SOUTH 1/2 OF THE SW 1/4 OF SECTION 12 EXCEPT THAT PART CONVEYED TO THE CITY OF AURORA BY DEED RECORDED JUNE 22, 1964 IN BOOK 157, PAGE 434.

I.) THE WEST 1/2 AND THE WEST 1/2 OF THE EAST 1/2 OF SECTION 13, EXCEPT THAT PART CONVEYED TO THE CITY OF AURORA BY DEED RECORDED JUNE 22, 1964 IN BOOK 157, PAGE 434.

J.) THE EAST 1/2; THE NW 1/4 AND THE NE 1/4 OF THE SW 1/4 OF SECTION 14.

K.) THE EAST 1/2 OF THE NE 1/4 AND THE NE 1/4 OF THE SE 1/4 OF SECTION 23.

L.) THE NW 1/4; THE WEST 1/2 OF THE NE 1/4; THE SE 1/4 OF THE NE 1/4 AND THE NORTH 1/2 OF THE SOUTH 1/2 OF SECTION 24.

M.) THE NW 1/4 OF THE NE 1/4; THE SE 1/4 OF THE NW 1/4 AND THE SOUTH 1/2 OF THE NE 1/4 OF THE NW 1/4 OF SECTION 25.

PARCEL 2 – INCLUSION (1982):

AS DESCRIBED IN THE INCLUSION AGREEMENT DATED JUNE 21, 1982 AND FILED AS BOOK 446, PAGE 26 IN THE OFFICE OF THE DOUGLAS COUNTY CLERK AND RECORDER.

THE NORTH HALF OF THE NORTH HALF OF THE SOUTHWEST QUARTER OF SECTION 1, TOWNSHIP 7 SOUTH, RANGE 69 WEST OF THE SIXTH PRINCIPAL MERIDIAN, COUNTY OF DOUGLAS, STATE OF COLORADO.

PARCEL 3 – INCLUSION (1985):

AS DESCRIBED IN THE INCLUSION AGREEMENT DATED SEPTEMBER 20, 1985 AND FILED AS BOOK 597, PAGE 495 IN THE OFFICE OF THE DOUGLAS COUNTY CLERK AND RECORDER.

SOUTH HALF OF THE NORTH HALF OF THE SOUTHWEST QUARTER OF SECTION 1, TOWNSHIP 7 SOUTH, RANGE 69 WEST OF THE SIXTH PRINCIPAL MERIDIAN, COUNTY OF DOUGLAS, STATE OF COLORADO, EXCEPT THAT TRACT OF LAND DESCRIBED IN BOOK 418 AT PAGE 317 OF THE REAL PROPERTY RECORDS OF THE DOUGLAS COUNTY, COLORADO, CLERK AND RECORDER.

PARCEL 4 - LAND SECURITIES INCLUSION (1988):

AS DESCRIBED IN THE INCLUSION AGREEMENT DATED DECEMBER 31, 1988 AND FILED AS BOOK 835, PAGE 543 IN THE OFFICE OF THE DOUGLAS COUNTY CLERK AND RECORDER.

A TRACT OF LAND LOCATED IN SECTION 35, TOWNSHIP 6 SOUTH, RANGE 69 WEST OF THE 6TH PRINCIPAL MERIDIAN, COUNTY OF DOUGLAS, STATE OF COLORADO, BEING MORE PARTICULARLY DESCRIBED AS FOLLOWS:

BEGINNING AT THE SOUTH ONE-QUARTER CORNER OF SAID SECTION 35;
THENCE S 89°45'23" W ALONG THE SOUTH LINE OF SAID SECTION 35 A
DISTANCE OF 219.03 FEET;
THENCE N 18°06'00" W A DISTANCE OF 3,646.27 FEET;
THENCE 130.57 FEET ALONG THE ARC OF A CURVE TO THE RIGHT HAVING A
CENTRAL ANGLE OF 22°27'41"; A RADIUS OF 333.07 FEET AND A CHORD WHICH BEARS
N 89°13'41" E, A CHORD DISTANCE OF 129.74 FEET;
THENCE S 79°32'28" E, A DISTANCE OF 602.46 FEET;
THENCE 246.31 FEET ALONG THE ARC OF A CURVE TO THE LEFT HAVING A
CENTRAL ANGLE OF 15°08'53", A RADIUS OF 931.65 FEET;
THENCE S 64°23'35" E A DISTANCE OF 258.44 FEET;
THENCE 167.91 FEET ALONG THE ARC OF A CURVE TO THE LEFT HAVING A CENTRAL ANGLE
OF 36°28'23", A RADIUS OF 263.77 FEET TO A POINT OF COMPOUND
CURVATURE;
THENCE 230.73 FEET ALONG THE ARC OF A CURVE TO THE LEFT HAVING A
CENTRAL ANGLE OF 93°44'52". A RADIUS OF 141.01 FEET;
THENCE N 14°36'49" W A DISTANCE OF 341.95 FEET;
THENCE 105.70 FEET ALONG THE ARC OF A CURVE TO THE RIGHT HAVING A CENTRAL
ANGLE OF 8°06'24", A RADIUS OF 747.06 FEET;

THENCE N 06°30'25" W, A DISTANCE OF 170.28 FEET;
THENCE 281.02 FEET ALONG THE ARC OF A CURVE TO THE LEFT HAVING A
CENTRAL ANGLE OF 13°43'54", A RADIUS OF 1,172.58 FEET TO A POINT OF
REVERSE CURVATURE,
THENCE 181.34 FEET ALONG THE ARC OF A CURVE TO THE RIGHT HAVING A
CENTRAL ANGLE OF 15°47'20", A RADIUS OF 658.06 FEET,
THENCE N 4°26'58" W, A DISTANCE OF 114.23 FEET;
THENCE 163.39 FEET ALONG THE ARC OF A CURVE TO THE RIGHT HAVING A CENTRAL
ANGLE OF 13°29'17", A RADIUS OF 694.05 FEET;
THENCE N 9°02'19" E A DISTANCE OF 93.09 FEET;
THENCE 238.88 FEET ALONG THE ARC OF A CURVE TO THE RIGHT HAVING A CENTRAL
ANGLE OF 33°00'45", A RADIUS OF 414.59 FEET;
THENCE N 42°03'04" E A DISTANCE OF 347.45 FEET;
THENCE 417.30 FEET ALONG THE ARC OF A CURVE TO THE RIGHT HAVING A CENTRAL
ANGLE OF 83°24'06", A RADIUS OF 286.68 FEET;
THENCE S 54°32'50" E A DISTANCE OF 256.66 FEET;
THENCE 239.58 FEET ALONG THE ARC OF A CURVE TO THE RIGHT HAVING A CENTRAL
ANGLE OF 14°38'06", A RADIUS OF 937.95 FEET;
THENCE S 39°54'44" E, A DISTANCE OF 216.09 FEET;
THENCE 225.96 FEET ALONG THE ARC OF A CURVE TO THE LEFT HAVING A CENTRAL
ANGLE OF 5°39'58" A RADIUS OF 2,284.93 FEET AND A CHORD WHICH BEARS
S 42°44'43" E, A CHORD DISTANCE OF 225.87 FEET;
THENCE S 00°25'06" E, A DISTANCE OF 620.15 FEET;
THENCE N 89°47'35" E, A DISTANCE OF 1,291.71 FEET;
THENCE S 00°07'06" E, A DISTANCE OF 1,324.92 FEET;
THENCE S 89°34'18" W A DISTANCE OF 4.04 FEET;
THENCE S 00°03'44" E A DISTANCE OF 843.10 FEET;
THENCE S 00°18'37" E, A DISTANCE OF 485.53 FEET;
THENCE S 89°35'38" W A DISTANCE OF 2,594.73 FEET;
THENCE S 00°30'52" E, A DISTANCE OF 1,326.31 FEET TO THE POINT OF BEGINNING,

CONTAINING 10,867,509 SQUARE FEET OR 249.2541 ACRES OF LAND, MORE OR LESS

THIS LEGAL DESCRIPTION WAS PREPARED BY PARAGON ENGINEERING CONSULTANTS, 5575
S. SYRACUSE STREET, SUITE 103, LITTLETON, CO 80120.

PARCEL 5 - SUMNER LAWRENCE INCLUSION (1995):

AS DESCRIBED IN THE INCLUSION AGREEMENT DATED NOVEMBER 9, 1995 AND FILED
AS BOOK 1301, PAGE 1898 IN THE OFFICE OF THE DOUGLAS COUNTY CLERK AND
RECORDER.

A PORTION OF THE SOUTH ONE-HALF OF THE SOUTHEAST ONE-QUARTER OF SECTION
3, TOWNSHIP 7 SOUTH, RANGE 69 WEST OF THE SIXTH PRINCIPAL MERIDIAN,
DOUGLAS COUNTY, COLORADO, BEING MORE PARTICULARLY DESCRIBED AS
FOLLOWS:

BASIS OF BEARINGS: THE EAST LINE OF THE SOUTH ONE-HALF OF THE SOUTHEAST
ONE-QUARTER OF SECTION 3, TOWNSHIP 7 SOUTH, RANGE 69 WEST OF THE SIXTH
PRINCIPAL MERIDIAN, DOUGLAS COUNTY, COLORADO, BEING MONUMENTED AT THE
SOUTHEAST CORNER OF SAID SECTION 3 BY A 3 1/2" BRASS CAP STAMPED "US
DEPARTMENT OF INTERIOR BUREAU OF LAND MANAGEMENT", AND AT THE
NORTHEAST CORNER OF THE SOUTH ONE-HALF OF THE SOUTHEAST ONE-QUARTER
OF SAID SECTION 3 BY A #5 REBAR WITH A YELLOW PLASTIC CAP STAMPED "LS 2682

N.H.P.O.” AND BEING ASSUMED TO BEAR NORTH 01 DEGREES 07 MINUTES 21 SECONDS WEST.

COMMENCING AT THE SOUTHEAST CORNER OF SAID SECTION 3, THENCE NORTH 01 DEGREES 07 MINUTES 21 SECONDS WEST AND ALONG THE EAST LINE OF THE SOUTH ONE-HALF OF THE SOUTHEAST ONE-QUARTER OF SAID SECTION 3 A DISTANCE OF 450 FEET TO THE POINT OF BEGINNING. THENCE NORTH 64 DEGREES 12 MINUTES 47 SECONDS WEST A DISTANCE OF 1082.97 FEET. THENCE SOUTH 72 DEGREES 10 MINUTES 01 SECONDS WEST A DISTANCE OF 1735.24 FEET TO A POINT ON THE WEST LINE OF THE SOUTH ONE-HALF OF THE SOUTHEAST ONE-QUARTER OF SAID SECTION 3. THENCE NORTH 01 DEGREES 49 MINUTES 56 SECONDS WEST AND ALONG THE WEST LINE OF THE SOUTH ONE-HALF OF THE SOUTHEAST ONE-QUARTER OF SAID SECTION 3 A DISTANCE OF 938.64 FEET TO THE NORTHWEST CORNER OF THE SOUTH ONE-HALF OF THE SOUTHEAST ONE QUARTER OF SAID SECTION 3. THENCE SOUTH 89 DEGREES 40 MINUTES 28 SECONDS EAST AND ALONG THE NORTH LINE OF THE SOUTH ONE-HALF OF THE SOUTHEAST ONE-QUARTER OF SAID SECTION 3, A DISTANCE OF 2640.13 FEET TO THE NORTHEAST CORNER OF THE SOUTH ONE-HALF OF THE SOUTHEAST ONE-QUARTER OF SAID SECTION 3. THENCE SOUTH 01 DEGREES 07 MINUTES 21 SECONDS EAST AND ALONG THE EAST LINE OF THE SOUTH ONE-HALF OF THE SOUTHEAST ONE-QUARTER OF SAID SECTION 3 A DISTANCE OF 863.04 FEET TO THE POINT OF BEGINNING.

THIS LEGAL DESCRIPTION WAS PREPARED BY JR ENGINEERING, LTD., 6110 GREENWOOD PLAZA BLVD., ENGLEWOOD, CO 80111, JEFFREY A. GUSTAFSON, SURVEYOR, P.L.S. 29039.

PARCEL 6 - SUMNER LAWRENCE INCLUSION (1995):

AS DESCRIBED IN THE INCLUSION AGREEMENT DATED NOVEMBER 9, 1995 AND FILED AS BOOK 1301, PAGE 1898 IN THE OFFICE OF THE DOUGLAS COUNTY CLERK AND RECORDER.

A PORTION OF THE SOUTH ONE-HALF OF THE SOUTHEAST ONE-QUARTER OF SECTION 3, TOWNSHIP 7 SOUTH, RANGE 69 WEST OF THE SIXTH PRINCIPAL MERIDIAN, DOUGLAS COUNTY, COLORADO, BEING MORE PARTICULARLY DESCRIBED AS FOLLOWS:

BASIS OF BEARINGS: THE EAST LINE OF THE SOUTH ONE-HALF OF THE SOUTHEAST ONE-QUARTER OF SECTION 3, TOWNSHIP 7 SOUTH, RANGE 69 WEST OF THE SIXTH PRINCIPAL MERIDIAN, DOUGLAS COUNTY, COLORADO BEING MONUMENTED AT THE SOUTHEAST CORNER OF SAID SECTION 3 BY A 3 1/2" BRASS CAP STAMPED "US DEPARTMENT OF INTERIOR BUREAU OF LAND MANAGEMENT", AND AT THE NORTHEAST CORNER OF THE SOUTH ONE-HALF OF THE SOUTHEAST ONE-QUARTER OF SAID SECTION 3 BY A #5 REBAR WITH A YELLOW PLASTIC CAP STAMPED "LS 2682 N.H.P.O." AND BEING ASSUMED TO BEAR NORTH 01 DEGREES 07 MINUTES 21 SECONDS WEST.

BEGINNING AT THE SOUTHEAST CORNER OF SAID SECTION 3, THENCE NORTH 89 DEGREES 33 MINUTES 24 SECONDS WEST AND ALONG THE SOUTH LINE OF THE SOUTH ONE-HALF OF THE SOUTHEAST ONE-QUARTER OF SAID SECTION 3 A DISTANCE OF 2624.07 FEET TO THE SOUTH ONE QUARTER CORFNER OF SAID SECTION 3; THENCE NORTH 01 DEGREES 49 MINUTES 56 SECONDS WEST AND ALONG THE WEST LINE OF THE SOUTH ONE-HALF OF THE SOUTHEAST ONE-QUARTER OF SAID SECTION 3 A DISTANCE OF 369.50 FEET; THENCE NORTH 72 DEGREES 10 MINUTES 01 SECONDS EAST A DISTANCE OF 1735.24 FEET; THENCE SOUTH 64 DEGREES 12

MINUTES 47 SECONDS EAST A DISTANCE OF 1082.97 FEET TO A POINT ON THE EAST LINE OF THE SOUTH ONE-HALF OF THE SOUTHEAST ONE-QUARTER OF SAID SECTION 3; THENCE SOUTH 01 DEGREES 07 MINUTES 21 SECONDS EAST AND ALONG THE EAST LINE OF THE SOUTH ONE-HALF OF THE SOUTHEAST ONE QUARTER OF SAID SECTION 3 A DISTANCE OF 450.00 FEET TO THE POINT OF BEGINNING, COUNTY OF DOUGLAS, STATE OF COLORADO.

THIS LEGAL DESCRIPTION WAS PREPARED BY JR ENGINEERING, LTD., 6110 GREENWOOD PLAZA BLVD., ENGLEWOOD, CO 80111, JEFFREY A. GUSTAFSON, SURVEYOR, P.L.S. 29039

PARCEL 7 - EAGLES NEST INCLUSION (2000):

AS DESCRIBED IN THE INCLUSION AGREEMENT DATED DECEMBER 8, 2000 AND FILED AS RECEPTION NUMBER 01009422 IN THE OFFICE OF THE DOUGLAS COUNTY CLERK AND RECORDER.

THE WEST 1/2 OF THE NORTHEAST 1/4 OF SECTION 23, TOWNSHIP 7 SOUTH, RANGE 69 WEST OF THE 6TH PRINCIPAL MERIDIAN, COUNTY OF DOUGLAS, STATE OF COLORADO EXCEPT THAT PORTION OF THE SOUTHWEST 1/4 OF THE NORTHWEST 1/4 CONVEYED IN BOOK 266 AT PAGE 934 OF THE DOUGLAS COUNTY, COLORADO RECORDS.

BEGINNING AT THE NORTHEAST CORNER OF THE NORTHWEST 1/4 OF THE NORTHEAST 1/4 OF SAID SECTION, THENCE ALONG THE EAST LINE OF THE WEST 1/2 OF THE NORTHEAST 1/4 OF SAID SECTION, THENCE ALONG THE EAST LINE OF THE WEST 1/2 OF THE NORTHEAST 1/4 OF SAID SECTION S00°44'29"E, A DISTANCE OF 1,171.69 FEET; THENCE S89°15'31"W, A DISTANCE OF 295.00 FEET; THENCE S00°44'29"E, A DISTANCE OF 238.00 FEET; THENCE N89°15'31"E, A DISTANCE OF 295.00 FEET; THENCE ALONG THE EAST LINE OF THE WEST 1/2 OF THE NORTHEAST 1/4 OF SAID SECTION S00°44'29"E, A DISTANCE OF 954.73 FEET; THENCE S89°14'25"W, A DISTANCE OF 1,309.39 FEET; THENCE N00°53'10"W, A DISTANCE OF 2,398.15 FEET TO THE NORTHWEST CORNER OF THE NORTHWEST 1/4 OF THE NORTHEAST 1/4 OF SAID SECTION; THENCE ALONG THE NORTH LINE OF SAID SECTION S89°17'28"E, A DISTANCE OF 1315.87 FEET TO THE POINT BEGINNING, CONTAINING 70.15 ACRES, MORE OR LESS.

PARCEL 8 – SUNRISE LAND INCLUSION (2001):

AS DESCRIBED IN THE INCLUSION AGREEMENT DATED OCTOBER 23, 2001 AND FILED AS BOOK 2188, PAGE 1344 IN THE OFFICE OF THE DOUGLAS COUNTY CLERK AND RECORDER.

A TRACT OF LAND SITUATED IN THE SOUTH 1/2 OF THE NORTH 1/2 OF THE SOUTH 1/2 OF SECTION 12, TOWNSHIP 7 SOUTH, RANGE 69 WEST OF THE 6TH PRINCIPLE MERIDIAN, MORE PARTICULARLY DESCRIBED AS FOLLOWS:

BEGINNING AT THE NORTHWEST CORNER OF THE SOUTH 1/2 OF THE NORTHWEST 1/4 OF THE SOUTHEAST 1/4 OF SAID SECTION 12 AND CONSIDERING THE NORTH LINE OF SAID SOUTH 1/2 OF THE NORTHWEST 1/4 OF THE SOUTHEAST 1/4 OF SAID SECTION 12 TO BEAR NORTH 89 DEGREES 34 MINUTES 40 SECONDS EAST WITH ALL BEARINGS CONTAINED HEREIN RELATIVE THERETO;

THENCE NORTH 89 DEGREES 34 MINUTES 40 SECONDS EAST ALONG SAID NORTH LINE A DISTANCE OF 1111.94 FEET TO A POINT THAT IS 200.00 FEET WEST OF THE

NORTHEAST CORNER OF THE SOUTH 1/2 OF THE NORTHWEST 1/4 OF THE SOUTHEAST
 1/4 OF SAID SECTION 12;
 THENCE SOUTH 0 DEGREES 17 MINUTES 21 SECONDS EAST PARALLEL WITH THE EAST
 LINE OF SAID SOUTH 1/2 OF THE NORTHWEST 1/4 A DISTANCE OF 753.11 FEET TO THE
 NORTH LINE OF THE COUNTY ROAD;
 THENCE NORTH 58 DEGREES 01 MINUTES 20 SECONDS WEST ALONG SAID NORTH LINE
 A DISTANCE OF 4.31 FEET;
 THENCE NORTH 75 DEGREES 38 MINUTES 00 SECONDS WEST ALONG SAID NORTH LINE
 A DISTANCE OF 702.43 FEET;
 THENCE NORTH 85 DEGREES 26 MINUTES 33 SECONDS WEST ALONG SAID NORTH LINE
 A DISTANCE OF 996.69 FEET;
 THENCE NORTH 76 DEGREES 53 MINUTES 55 SECONDS WEST ALONG SAID NORTH LINE
 A DISTANCE OF 587.28 FEET;
 THENCE NORTH 70 DEGREES 39 MINUTES 06 SECONDS WEST ALONG SAID NORTH LINE
 A DISTANCE OF 400.31 FEET;
 THENCE NORTH 87 DEGREES 51 MINUTES 57 SECONDS WEST ALONG SAID NORTH LINE
 A DISTANCE OF 113.31 FEET;
 THENCE SOUTH 81 DEGREES 04 MINUTES 08 SECONDS WEST ALONG SAID NORTH LINE
 A DISTANCE OF 150.95 FEET;
 THENCE SOUTH 67 DEGREES 20 MINUTES 53 SECONDS WEST ALONG SAID NORTH LINE
 A DISTANCE OF 362.66 FEET;
 THENCE NORTH 85 DEGREES 02 MINUTES 05 SECONDS WEST ALONG SAID NORTH LINE
 A DISTANCE OF 98.76 FEET;
 THENCE SOUTH 84 DEGREES 51 MINUTES 41 SECONDS WEST ALONG SAID NORTH LINE
 A DISTANCE OF 169.82 FEET;
 THENCE NORTH 01 DEGREE 51 MINUTES 30 SECONDS WEST ALONG THE EAST LINE OF
 THE COUNTY ROAD A DISTANCE OF 371.53 FEET TO THE NORTH LINE OF THE SOUTH
 1/2 OF THE NORTH 1/2 OF THE SOUTHWEST 1/4 OF SECTION 12;
 THENCE NORTH 89 DEGREES 34 MINUTES 40 SECONDS EAST ALONG SAID NORTH LINE
 A DISTANCE OF 2388.32 FEET TO THE TRUE POINT OF BEGINNING, COUNTY OF
 DOUGLAS, STATE OF COLORADO.

PARCEL 9 – LOCKHEED MARTIN INCLUSION (2003):

AS DESCRIBED IN THE INCLUSION AGREEMENT DATED JANUARY 15, 2003.

MARTIN –MARIETTA
 SECS. 15, 16, 17, 19, 20, 21, 22, 27, 28, 29, 30, 31, 32, 33, 34
 T. 6S., R. 69W. OF THE 6TH P.M.

A PARCEL OF LAND LOCATED IN SECTION 15, 16, 17, 19, 20, 21, 22, 27, 28, 29, 30, 31, 32, 33,
 AND 34, TOWNSHIP 6 SOUTH, RANGE 69 WEST OF THE SIXTH PRINCIPAL MERIDIAN,
 BEING MORE PARTICULARLY DESCRIBED AS FOLLOWS:
 BEGINNING AT THE SOUTHWEST CORNER OF THE SOUTHEAST QUARTER OF SAID
 SECTION 17; THENCE N 00°14'03"W ALONG THE WESTERLY LINE OF SAID SOUTHEAST
 QUARTER OF SECTION 17 A DISTANCE OF 2604.62 FEET; THENCE N 89°53'21"E ALONG
 THE NORTHERLY LINE OF SAID SOUTHEAST QUARTER OF SECTION 17 A DISTANCE OF
 2315.13 FEET; THENCE N 00°13'51"W ALONG THE WESTERLY LINE OF THE EAST HALF OF
 THE EAST HALF OF THE SOUTHEAST QUARTER OF THE NORTHEAST QUARTER OF SAID
 SECTION 17 A DISTANCE OF 1313.44 FEET; THENCE N 89°35'12"E ALONG THE
 NORTHERLY LINE OF SAID EAST HALF OF THE EAST HALF OF THE SOUTHEAST
 QUARTER OF THE NORTHEAST OF SECTION 17 A DISTANCE OF 330.32 FEET; THENCE
 S 00°13'31"E ALONG THE EASTERLY LINE OF SAID EAST HALF OF THE EAST HALF OF
 THE SOUTHEAST QUARTER OF THE NORTHEAST QUARTER OF SECTION 17 A DISTANCE
 OF 1315.24 FEET; THENCE N 89°15'35"E ALONG THE NORTHERLY LINE OF THE SOUTH

HALF OF SAID SECTION 16 A DISTANCE OF 5187.12 FEET; THENCE S 00°32'12"E ALONG THE EASTERLY LINE OF SAID SOUTH HALF OF SECTION 16 A DISTANCE OF 1329.88 FEET; THENCE N 89°14'37"E ALONG THE NORTHERLY LINE OF THE SOUTH HALF OF THE SOUTHWEST QUARTER OF SAID SECTION 15 A DISTANCE OF 2643.82 FEET; THENCE N 89°13'23"E ALONG THE NORTHERLY LINE OF THE SOUTH HALF OF THE SOUTHEAST QUARTER OF SAID SECTION 15 A DISTANCE OF 1814.48 FEET; THENCE S 26°59'33"E A DISTANCE OF 1480.18 FEET TO THE SOUTHERLY LINE OF SAID SOUTHEAST QUARTER OF SECTION 15; THENCE S 00°26'26"E ALONG THE EASTERLY LINE OF THE WEST HALF OF THE EAST HALF OF THE NORTHEAST QUARTER OF THE NORTHEAST QUARTER OF THE NORTHEAST QUARTER OF SAID SECTION 22 A DISTANCE OF 670.22 FEET; THENCE N 89°23'06"E ALONG THE SOUTHERLY LINE OF SAID WEST HALF OF THE EAST HALF OF THE NORTHEAST QUARTER OF THE NORTHEAST QUARTER OF THE NORTHEAST QUARTER OF SAID SECTION 22 A DISTANCE OF 164.65 FEET; THENCE S 00°24'30"E ALONG THE EASTERLY LINE OF THE NORTHEAST QUARTER OF SAID SECTION 22 A DISTANCE OF 2011.82 FEET; THENCE S 00°25'40"E ALONG THE EASTERLY LINE OF THE SOUTHEAST QUARTER OF SAID SECTION 22 A DISTANCE OF 2686.77 FEET; THENCE S 09°20'23"W ALONG THE WESTERLY DEED LINE OF THAT PARCEL OF LAND DESCRIBED IN BOOK 2112, PAGE 29, JEFFERSON COUNTY CLERK AND RECORDER'S OFFICE A DISTANCE OF 1480.97 FEET; THENCE ALONG THE DEED LINE OF THAT PARCEL OF LAND DESCRIBED IN BOOK 2833, PAGE 135, JEFFERSON COUNTY CLERK AND RECORDER'S OFFICE THE FOLLOWING FIVE (5) COURSES:

1. N 46°05'02"W A DISTANCE OF 1.61 FEET;
2. THENCE N 72°13'14"W A DISTANCE OF 795.57 FEET;
3. THENCE S 12°56'12"E A DISTANCE OF 678.43 FEET;
4. THENCE S 69°14'54"E A DISTANCE OF 56.73 FEET;
5. THENCE S 68°49'04"E A DISTANCE OF 36.14 FEET;

THENCE S 67°50'10"E ALONG THE SOUTHERLY DEED LINE OF THAT PARCEL OF LAND DESCRIBED IN BOOK 1097, PAGE 148, JEFFERSON COUNTY CLERK AND RECORDER'S OFFICE A DISTANCE OF 327.44 FEET; THENCE ALONG THE DEED LINES OF THAT PARCEL OF LAND DESCRIBED IN SAID BOOK 2112, PAGE 29, JEFFERSON COUNTY CLERK AND RECORDER'S OFFICE THE FOLLOWING SIX (6) COURSES:

1. S 17°17'16"W A DISTANCE 600.35 FEET;
2. THENCE S 14°44'00"E A DISTANCE OF 1345.91 FEET;
3. THENCE S 14°18'17"W A DISTANCE OF 742.53 FEET;
4. THENCE S 32°11'41"E ALONG A LINE NON-TANGENT WITH THE FOLLOWING DESCRIBED CURVE A DISTANCE OF 200.14 FEET;
5. THENCE ALONG THE ARC OF A CURVE TO THE RIGHT HAVING A CENTRAL ANGLE OF 16°12'43", A RADIUS OF 949.23 FEET, A CHORD BEARING S 65°07'22"W A DISTANCE OF 267.69 FEET, AND AN ARC DISTANCE OF 268.59 FEET;
6. THENCE S 00°29'37"E ALONG A LINE NON-TANGENT WITH THE LAST DESCRIBED CURVE A DISTANCE OF 304.15 FEET;

THENCE S 89°27'35"W ALONG THE SOUTHERLY LINE OF THE SOUTHEAST QUARTER OF SAID SECTION 27 A DISTANCE OF 1976.93 FEET; THENCE S 89°29'27"W ALONG THE SOUTHERLY LINE OF THE SOUTHEAST QUARTER OF THE SOUTHWEST QUARTER OF SAID SECTION 27 A DISTANCE OF 1317.59 FEET; THENCE S 00°17'38"E ALONG THE EASTERLY LINE OF THE NORTHWEST QUARTER OF THE NORTHWEST QUARTER OF SAID SECTION 34, A DISTANCE OF 1318.51 FEET; THENCE S 89°29'33"W ALONG THE SOUTHERLY LINE OF SAID NORTHWEST QUARTER OF THE NORTHWEST QUARTER OF SECTION 34 A DISTANCE OF 1312.38 FEET; THENCE S 89°27'33"W ALONG THE SOUTHERLY LINE OF THE NORTH HALF OF THE NORTHEAST QUARTER OF SAID SECTION 33 A DISTANCE OF 2583.92 FEET; THENCE S 89°21'21"W ALONG THE SOUTHERLY LINE OF THE NORTH HALF OF THE NORTHWEST QUARTER OF SAID SECTION 33 A DISTANCE OF 2582.03 FEET; THENCE S 00°18'58"E ALONG THE EASTERLY LINE OF THE SOUTHEAST QUARTER OF THE NORTHEAST QUARTER OF SAID SECTION 32 A DISTANCE OF 1305.32 FEET; THENCE S 89°48'01"W

ALONG THE SOUTHERLY LINE OF SAID SOUTHEAST QUARTER OF THE NORTHEAST QUARTER A DISTANCE OF 1283.74 FEET; THENCE S 00°19'09"E ALONG THE EASTERLY LINE OF THE NORTHWEST QUARTER OF THE SOUTHEAST QUARTER OF SAID SECTION 32 A DISTANCE OF 1304.37 FEET, THENCE S 89°50'35"W ALONG THE SOUTHERLY LINE OF SAID NORTHWEST QUARTER OF THE SOUTHEAST QUARTER OF SECTION 32 A DISTANCE OF 1283.67 FEET; THENCE S 89°37'01"W ALONG THE SOUTHERLY LINE OF THE NORTH HALF OF THE SOUTHWEST QUARTER A DISTANCE OF 2588.98 FEET; THENCE S 89°20'51"W ALONG THE SOUTHERLY LINE OF THE NORTH HALF OF THE SOUTHEAST QUARTER OF SAID SECTION 31 A DISTANCE OF 2610.38 FEET; THENCE N 00°38'17"W ALONG THE WESTERLY LINE OF SAID NORTH HALF OF THE SOUTHEAST QUARTER OF SECTION 31 A DISTANCE OF 1307.68 FEET; THENCE N 89°15'41"E ALONG THE NORTHERLY LINE OF SAID NORTH HALF OF THE SOUTHEAST QUARTER OF SAID SECTION 31 A DISTANCE OF 1312.34 FEET; THENCE N 00°19'30"W ALONG THE WESTERLY LINE OF THE EAST HALF OF THE NORTHEAST QUARTER OF SAID SECTION 31 A DISTANCE OF 2619.32; THENCE N 00°19'31"W ALONG THE WESTERLY LINE OF THE EAST HALF OF THE SOUTHEAST QUARTER OF SAID SECTION 30 A DISTANCE OF 2641.69 FEET; THENCE S 89°15'41"W ALONG THE SOUTHERLY LINE OF THE SOUTHWEST QUARTER OF THE NORTHEAST QUARTER OF SAID SECTION 30 A DISTANCE OF 1315.36 FEET; THENCE S 89°15'41"W ALONG THE SOUTHERLY LINE OF THE SOUTHEAST QUARTER OF THE NORTHWEST QUARTER OF SAID SECTION 30 A DISTANCE OF 1309.42 FEET; THENCE N 00°01'57"E ALONG THE WESTERLY LINE OF SAID SOUTHEAST QUARTER OF THE NORTHWEST QUARTER OF SECTION 30 A DISTANCE OF 1331.46 FEET; THENCE N 89°26'40"E ALONG THE NORTHERLY LINE OF SAID SOUTHEAST QUARTER OF THE NORTHWEST QUARTER OF SECTION 30 A DISTANCE OF 1306.73 FEET; THENCE N 89°26'37"E ALONG THE NORTHERLY LINE OF SAID SOUTHWEST QUARTER OF THE NORTHEAST QUARTER OF SECTION 30 A DISTANCE OF 1309.70 FEET; THENCE N 00°19'30"W ALONG THE WESTERLY LINE OF THE NORTHEAST QUARTER OF THE NORTHEAST QUARTER OF SAID SECTION 30 A DISTANCE OF 1323.03 FEET; THENCE N 01°29'35"W ALONG THE WESTERLY LINE OF THE SOUTHEAST QUARTER OF THE SOUTHEAST QUARTER OF SAID SECTION 19 A DISTANCE OF 1339.76 FEET; THENCE N 89°40'12"E ALONG THE NORTHERLY LINE OF SAID SOUTHEAST QUARTER OF SOUTHEAST QUARTER A DISTANCE OF 1306.56 FEET; THENCE N 89°56'55"E ALONG THE NORTHERLY LINE OF THE SOUTHWEST QUARTER OF THE SOUTHWEST QUARTER OF SAID SECTION 20 A DISTANCE OF 1278.91 FEET; THENCE N 01°34'20"W ALONG THE EASTERLY LINE OF THE NORTHEAST QUARTER OF THE SOUTHWEST QUARTER OF SAID SECTION 20 A DISTANCE OF 1334.91 FEET; THENCE N 89°50'36"W ALONG THE SOUTHERLY LINE OF THE SOUTHWEST QUARTER OF SAID SECTION 20 A DISTANCE OF 1275.06 FEET; THENCE S 89°41'50"W ALONG THE SOUTHERLY LINE OF THE NORTHEAST QUARTER OF SAID SECTION 19 A DISTANCE OF 2617.38 FEET; THENCE N 01°35'29"W ALONG THE WESTERLY LINE OF SAID NORTHEAST QUARTER OF SECTION 19 A DISTANCE OF 2668.84 FEET; THENCE N 89°32'06"E ALONG THE NORTHERLY LINE OF SAID NORTHEAST QUARTER OF SECTION 19 A DISTANCE OF 2626.68 FEET; THENCE S 89°34'25"E ALONG THE NORTHERLY LINE OF THE NORTHWEST QUARTER OF SAID SECTION 20 A DISTANCE OF 2533.62 FEET TO THE POINT OF BEGINNING.

SAID PARCEL CONTAINS 5540.439 ACRES, MORE OR LESS.

EXCEPTING THEREFROM THE FOLLOWING DESCRIBED PARCEL OF LAND:

COMMENCING AT THE SOUTHEAST CORNER OF SAID SECTION 27, WHENCE THE EAST QUARTER CORNER OF SAID SECTION 27 BEARS N 00°32'04"W A DISTANCE OF 2602.61 FEET; THENCE N 15°53'50"W A DISTANCE OF 1857.95 FEET TO THE POINT OF BEGINNING; THENCE

S 00°26'42"E ALONG THE EASTERLY LINES OF THE SOUTHWEST QUARTER OF THE NORTHWEST QUARTER OF THE SOUTHEAST QUARTER OF THE NORTHEAST QUARTER OF THE SOUTHEAST QUARTER AND THE NORTHWEST QUARTER OF THE SOUTHWEST QUARTER OF THE SOUTHEAST QUARTER OF THE NORTHEAST QUARTER OF THE SOUTHEAST QUARTER OF SAID SECTION 27 A DISTANCE OF 325.69 FEET; THENCE S 89°40'46"W ALONG THE SOUTHERLY LINE OF SAID NORTHWEST QUARTER OF THE SOUTHWEST QUARTER OF THE SOUTHEAST QUARTER OF THE NORTHEAST QUARTER OF THE SOUTHEAST QUARTER OF SECTION 27 A DISTANCE OF 140.09 FEET; THENCE ALONG THE DEED LINE OF THAT PARCEL OF LAND DESCRIBED IN RECEPTION NO. 92033440, JEFFERSON COUNTY CLERK AND RECORDER'S OFFICE THE FOLLOWING TWO (2) COURSES:

1. S 89°04'06"W A DISTANCE OF 138.47 FEET;
2. THENCE N 02°51'44"E A DISTANCE OF 1.48 FEET; THENCE S 89°40'46"W ALONG THE SOUTHERLY LINE OF THE NORTHEAST QUARTER OF THE SOUTHEAST QUARTER OF THE SOUTHWEST QUARTER OF THE NORTHEAST QUARTER OF THE SOUTHEAST QUARTER OF THE SAID SECTION 27 A DISTANCE OF 50.00 FEET; THENCE N 00°25'37"W ALONG THE WESTERLY LINES OF THE NORTHEAST QUARTER OF THE SOUTHEAST QUARTER OF THE SOUTHWEST QUARTER OF THE NORTHEAST QUARTER OF THE SOUTHEAST QUARTER AND THE SOUTHEAST QUARTER OF THE NORTHEAST QUARTER OF THE SOUTHWEST QUARTER OF THE NORTHEAST QUARTER OF THE SOUTHEAST QUARTER OF SAID SECTION 27 A DISTANCE OF 325.97 FEET; THENCE N 89°43'37"E ALONG THE NORTHERLY LINES OF THE SOUTHEAST QUARTER OF THE NORTHEAST QUARTER OF THE SOUTHWEST QUARTER OF THE NORTHEAST QUARTER OF THE SOUTHEAST QUARTER AND THE SOUTHWEST QUARTER OF THE NORTHWEST QUARTER OF THE SOUTHEAST QUARTER OF THE NORTHEAST QUARTER OF THE SOUTHEAST QUARTER OF SAID SECTION 27 A DISTANCE OF 328.36 FEET TO THE POINT OF BEGINNING, COUNTY OF JEFFERSON, STATE OF COLORADO.

SAID PARCEL CONTAINS 2.459 ACRES MORE OR LESS

PARCEL CONTAINS 5537.98 NET ACRES, MORE OR LESS.

PARCEL 10 - LEGAL DESCRIPTION OF EXCLUDED PROPERTY - GOODWIN EXCLUSION (2007)

EXCLUDING THEREFROM THE FOLLOWING DESCRIBED PROPERTY AS DESCRIBED IN THE EXCLUSION AGREEMENT DATED AUGUST 09, 2007.

THE SOUTHEAST 1/4 NORTHWEST 1/4 AND THE SOUTH ½ NORTHEAST 1/4 NORTHWEST 1/4 OF SECTION 25, TOWNSHIP 7 SOUTH, RANGE 69 WEST OF THE 6TH P.M., COUNTY OF DOUGLAS, STATE OF COLORADO.

AND

THE NORTHWEST 1/4 OF THE NORTHEAST 1/4 OF SECTION 25, TOWNSHIP 7 SOUTH, RANGE 69 WEST OF THE 6TH P.M., COUNTY OF DOUGLAS, STATE OF COLORADO, EXCEPTING THEREFROM PROPERTY CONVEYED IN DEED RECORDED JULY 29, 1987 IN BOOK 737 AT PAGE 596 OF THE DOUGLAS COUNTY, COLORADO RECORDS.

AND

A PARCEL OF LAND LOCATED IN THE NORTHWEST ONE-QUARTER OF THE NORTHEAST ONE-QUARTER OF SECTION 25, TOWNSHIP 7 SOUTH, RANGE 69 WEST OF THE SIXTH PRINCIPAL MERIDIAN, COUNTY OF DOUGLAS, STATE OF COLORADO, MORE PARTICULARLY DESCRIBED AS FOLLOWS:

COMMENCING AT THE SOUTHWEST CORNER OF THE SOUTHEAST ONE-QUARTER OF SAID NORTHEAST ONE-QUARTER OF SAID SECTION 25; THENCE N 00°20'27"W ALONG THE WEST LINE OF THE EAST ONE-HALF OF SAID NORTHEAST ONE-QUARTER A DISTANCE OF 1,315.67 FEET TO THE SOUTHEAST CORNER OF SAID NORTHWEST ONE-QUARTER OF THE NORTHEAST ONE-QUARTER; THENCE N 88°34'08"W ALONG THE SOUTH LINE OF SAID NORTHWEST ONE-QUARTER A DISTANCE OF 608.83 FEET TO THE POINT BEGINNING; THENCE N 45°57'14"E A DISTANCE OF 328.93 FEET TO A PIN & CAP, L.S. #16112;

THENCE N 54°51'22"W A DISTANCE OF 131.26 FEET TO A PIN & CAP, L.S. #16112; THENCE N 90°00'00"W A DISTANCE OF 25.00 FEET TO A PIN & CAP, L.S. #16112; THENCE N 52°32'50"W A DISTANCE OF 173.45 FEET TO A PIN & CAP, L.S. #16112; THENCE S 59°17'01"W A DISTANCE OF 167.56 FEET TO A PIN & CAP, L.S. #16112; THENCE S 24°55'54"W A DISTANCE OF 274.18 FEET TO A PIN & CAP, L.S. #16112; ON THE SOUTHWESTERLY EDGE OF AN EXISTING DIRT ROAD; THENCE S 46°29'27"E ALONG SAID EDGE OF ROAD A DISTANCE OF 101.69 FEET TO A POINT ON THE SOUTH LINE OF SAID NORTHWEST ONE-QUARTER; THENCE S 88°34'08"E ALONG SAID SOUTH LINE A DISTANCE OF 219.55 FEET TO THE POINT OF BEGINNING;

EXCEPTING THEREFROM THE FOLLOWING PROPERTY:

A PARCEL OF LAND SITUATED IN THE NW 1/4 OF THE NE 1/4 OF SECTION 25, LYING NORTH AND EAST OF THE WEST BOUNDARY OF THE EXISTING ROAD KNOWN AS COUNTY ROAD NO. 5 (OR OLD THOMAS ROAD SURVEYED FEBRUARY 10, 1890 DOUGLAS COUNTY RECORDS, PLAT BOOK 2 PAGE 17).

ALL IN TOWNSHIP 7 SOUTH, RANGE 69 WEST OF THE 6TH P.M., COUNTY OF DOUGLAS, STATE OF COLORADO.

THIS DESCRIPTION WAS PREPARED BY ROXBOROUGH PARK METROPOLITAN DISTRICT; 6222 N. ROXBOROUGH PARK ROAD, LITTLETON, CO 80125.

PARCEL 11 - LEGAL DESCRIPTION OF INCLUDED PROPERTY - MONROE INCLUSION (2007)

INCLUDING THEREFROM THE FOLLOWING DESCRIBED PROPERTY AS DESCRIBED IN THE INCLUSION AGREEMENT DATED NOVEMBER 14, 2007.

COMMENCING AT THE NORTHEAST CORNER OF THE NORTHWEST ¼ OF THE NORTHEAST ¼ OF SAID SECTION 23; THENCE ALONG THE EAST LINE OF THE WEST ½ OF THE NORTHEAST ¼ OF SAID SECTION 23, S 0°44'29" E, A DISTANCE OF 1178.93 FEET TO THE NORTHWEST CORNER OF LOT 123 SAID POINT BEING THE POINT OF BEGINNING; THENCE S 72°57'48" E, A DISTANCE OF 107.49 FEET TO A POINT ON THE WESTERLY LINE OF PONDEROSA TRAIL, SAID POINT BEING A POINT OF NONTANGENT CURVATURE; THENCE 181.15 FEET ALONG THE ARC OF SAID CURVE TO THE LEFT, CONTAINING A RADIUS OF 315.40 FEET AN INTERIOR ANGLE OF 32°54'25" AND A CHORD OF 178.67 FEET WHICH BEARS S 00°35'09" W TO A POINT; THENCE S 74°07'45" W, A DISTANCE OF 101.76 FEET TO THE SOUTHWEST CORNER OF SAID LOT 123; THENCE S 89°15'31" W, A DISTANCE OF 295.00 FEET TO A POINT; THENCE N. 00°44'29" W, A DISTANCE OF 238.00 FEET TO A POINT; THENCE N 89°15'31" E, A DISTANCE OF 295.00 TO THE POINT OF BEGINNING.

PARCEL 12 - LEGAL DESCRIPTION OF INCLUDED PROPERTY - KETCHUM INCLUSION (2008)

INCLUDING THEREFROM THE FOLLOWING DESCRIBED PROPERTY AS DESCRIBED IN THE INCLUSION AGREEMENT DATED MARCH 04, 2008.

BEGINNING AT THE SOUTHEAST CORNER OF SAID NORTH ½ OF THE SOUTHWEST ¼; THENCE S 89°37'55" W ALONG THE SOUTH LINE OF SAID NORTH ½ OF THE SOUTHWEST ¼ A DISTANCE OF 776.31 FEET TO A POINT ON THE SOUTHERLY LINE OF SAID COMMERCIAL BUILDING AREA 2; THENCE N 68°59'59" W ALONG THE SOUTH LINE OF SAID COMMERCIAL BUILDING AREA A DISTANCE OF 25.97 FEET; THENCE N 83°59'59" W ALONG SAID SOUTH LINE A DISTANCE OF 285.00 FEET; THENCE S 61°09'31" W ALONG SAID SOUTH LINE A DISTANCE OF 86.15 FEET TO THE SOUTH LINE OF SAID N ½ OF THE SW ¼; THENCE S 89°37'55" W ALONG SAID SOUTH LINE A DISTANCE OF 1215.41 FEET TO THE SOUTHEAST CORNER OF THAT TRACT OF LAND DESCRIBED IN BOOK 282 AT PAGE 24 OF THE DOUGLAS COUNTY RECORDS; THENCE N 4°48'28" E ALONG THE EAST LINE OF SAID TRACT A DISTANCE OF 215.53 TO THE NORTHEAST CORNER OF SAID TRACT AND TO A POINT ON THE SOUTH RIGHT OF WAY LINE OF THE EXISTING COUNTY ROAD; THENCE N 84°57'06" E ALONG SAID SOUTH RIGHT OF WAY LINE A DISTANCE OF 150.76 FEET; THENCE ALONG THE ARC OF A CURVE TO THE LEFT AND ALONG SAID SOUTH RIGHT OF WAY LINE A DISTANCE OF 204.59 FEET, SAID CURVE HAS A RADIUS OF 576.00 FEET AND A CENTRAL ANGLE OF 20°21'05" AND A CHORD THAT BEARS N 77°07'24" E A DISTANCE OF 203.52 FEET; THENCE N 69°17'43" E ALONG SAID SOUTH RIGHT OF WAY LINE A DISTANCE OF 272.95 FEET; THENCE ALONG THE ARC OF A CURVE TO THE RIGHT AND ALONG SAID SOUTH RIGHT OF WAY LINE A DISTANCE OF 282.69 FEET; SAID CURVE HAS A RADIUS OF 881.00 FEET AND A CENTRAL ANGLE OF 18°23'05" AND A CHORD THAT BEARS N 89°21'08" E A DISTANCE OF 281.48 FEET; THENCE S 70°35'26" E ALONG SAID SOUTH RIGHT OF WAY LINE A DISTANCE OF 121.01 FEET; THENCE ALONG THE ARC OF A CURVE TO THE TRIGHT AND ALONG SAID SOUTH RIGHT OF WAY LINE A DISTANCE OF 303.00 FEET; SAID CURVE HAS A RADIUS OF 2842.00 FEET AND A CENTRAL ANGLE OF 6°06'31" AND A CHORD THAT BEARS S 72°16'50" E A DISTANCE OF 302.86 FEET; THENCE S 76°41'57" E ALONG SAID SOUTH RIGHT OF WAY LINE A DISTANCE OF 349.41 FEET; THENCE ALONG THE ARC OF A CURVE TO THE LEFT AND ALONG SAID SOUTH RIGHT OF WAY LINE A DISTANCE OF 295.27 FEET, SAID CURVE HAS A RADIUS OF 1503.00 FEET AND A CENTRAL ANGLE OF 10°33'13" AND A CHORD THAT BEARS S 81°14'35" E A DISTANCE OF 294.85 FEET; THENCE S 85°47'13" E ALONG SAID SOUTH RIGHT OF WAY LINE A DISTANCE OF 424.59 FEET TO THE EAST LINE OF THE NORTH ½ OF THE SOUTHWEST ¼ OF SAID SECTION 12; THENCE S 0°15'17" E ALONG SAID EAST LINE A DISTANCE OF 67.34 FEET TO THE POINT OF BEGINNING.

PARCEL 13 - LEGAL DESCRIPTION OF INCLUDED PROPERTY - CAVEY INCLUSION (2012)

INCLUDING THEREFROM THE FOLLOWING DESCRIBED PROPERTY AS DESCRIBED IN THE INCLUSION AGREEMENT DATED JANUARY 27, 2012.

40 ACRES LOCATED ON THE EAST SIDE OF RAMPART ROAD AND WEST OF THE DENVER WATER BOARD'S FOOTHILLS WATER TREATMENT PLANT AND MORE PARTICULARLY DESCRIBED AS SW ¼ SECTION 1, TOWNSHIP 7 SOUTH, RANGE 69 WEST, COUNTY OF DOUGLAS, STATE OF COLORADO.

**PARCEL 14 - LEGAL DESCRIPTION OF INCLUDED PROPERTY – ARS-NORMAN
INCLUSION (2012)**

INCLUDING THEREFROM THE FOLLOWING DESCRIBED PROPERTY AS DESCRIBED IN
THE INCLUSION AGREEMENT DATED JANUARY 27, 2012.

THE NORTHEAST QUARTER (NE 1/4) OF SECTION 1, TOWNSHIP 7 SOUTH, RANGE 69
WEST OF THE 6TH PRINCIPAL MERIDIAN, COUNTY OF DOUGLAS, STATE OF COLORADO

EXCEPT THAT PART CONVEYED IN DEED RECORDED NOVEMBER 26, 1975 IN BOOK 282
AT PAGE 876 AND DESCRIBED AS FOLLOWS:

A PARCEL OF LAND SITUATED IN THE NORTHEAST QUARTER (NE ¼) OF SECTION 1,
TOWNSHIP 7 SOUTH, RANGE 69 WEST OF THE SIXTH PRINCIPAL MERIDIAN, COUNTY
OF DOUGLAS, STATE OF COLORADO, MORE PARTICULARLY DESCRIBED AND
BOUNDED AS FOLLOWS:

BEGINNING AT THE EAST QUARTER CORNER OF SAID SECTION 1; THENCE SOUTH 88
DEGREES 29 MINUTES 41 SECONDS WEST ALONG THE EAST-WEST CENTERLINE OF
SAID SECTION 1, A DISTANCE OF 160.06 FEET TO A POINT; THENCE NORTH 0 DEGREES
20 MINUTES 52 SECONDS WEST 160 FEET WESTERLY OF AND PARALLEL WITH THE
EAST LINE OF SAID SECTION 1, A DISTANCE OF 688.24 FEET TO A POINT; THENCE
SOUTH 89 DEGREES 39 MINUTES 08 SECONDS WEST, A DISTANCE OF 20.00 FEET TO A
POINT; THENCE NORTH 0 DEGREES 20 MINUTES 52 SECONDS WEST PARALLEL WITH
THE EAST LINE OF SAID SECTION 1, A DISTANCE OF 225.00 FEET TO A POINT; THENCE
SOUTH 89 DEGREES 39 MINUTES 08 SECONDS WEST A DISTANCE OF 100.00 FEET TO A
POINT; THENCE NORTH 0 DEGREES 20 MINUTES 52 SECONDS WEST PARALLEL WITH
THE EAST LINE OF SAID SECTION 1, A DISTANCE OF 50.00 FEET TO A POINT; THENCE
NORTH 89 DEGREES 39 MINUTES 08 SECONDS EAST, A DISTANCE OF 100.00 FEET TO A
POINT; THENCE NORTH 0 DEGREES 20 MINUTES 52 SECONDS WEST PARALLEL WITH
THE EAST LINE OF SAID SECTION 1, A DISTANCE OF 225.00 FEET TO A POINT; THENCE
NORTH 89 DEGREES 39 MINUTES 08 SECONDS EAST, A DISTANCE OF 50.00 FEET TO A
POINT; THENCE NORTH 0 DEGREES 20 MINUTES 52 SECONDS WEST 130 FEET
WESTERLY OF AND PARALLEL WITH THE EAST LINE OF SAID SECTION 1, A DISTANCE
OF 1406.79 FEET TO A POINT ON THE NORTH LINE OF SAID SECTION 1; THENCE NORTH
89 DEGREES 39 MINUTES 59 SECONDS EAST, ALONG THE NORTH LINE OF SAID
SECTION 1, A DISTANCE OF 130.00 FEET TO THE NORTHEAST CORNER OF SAID
SECTION 1; THENCE SOUTH 0 DEGREES 20 MINUTES 52 SECONDS EAST, ALONG THE
EAST LINE OF SAID SECTION 1, A DISTANCE OF 2591.8 FEET, MORE OR LESS TO THE
POINT OF BEGINNING.

AND EXCEPT THAT PART DESCRIBED IN DEED RECORDED MARCH 12, 1998 IN BOOD
1522 AT PAGE 1991 BEING DESCRIBED AS FOLLOWS:

A PARCEL OF LAND BEING A PORTION OF THE NORTHEAST QUARTER OF SECTION 1,
TOWNSHIP 7 SOUTH, RANGE 69 WEST OF THE SIXTH PRINCIPAL MERIDIAN, COUNTY
OF DOUGLAS, STATE OF COLORADO MORE PARTICULARLY DESCRIBED AS FOLLOWS:
BEGINNING AT A POINT ON THE WESTERLY BOUNDARY OF DENVER WATER
PROPERTY FOR CONDUIT NUMBER 27 AND THE NORTH BOUNDARY OF SAID DENVER'S
PROPERTY FOR THE FOOTHILLS FILTER SITE FROM WHICH THE EAST QUARTER
CORNER OF SAID SECTION 1 BEARS NORTH 88 DEGREES 29 MINUTES 11 SECONDS EAST
160.06 FEET; THENCE ALONG SAID NORTH BOUNDARY TO THE CENTER OF QUARTER
CORNER OF SAID SECTION 1, SOUTH 88 DEGREES 29 MINUTES 11 SECONDS WEST
2473.79 FEET; THENCE ALONG THE WEST LINE OF THE NORTHEAST QUARTER OF SAID
SECTION 1 TO THE NORTH QUARTER CORNER NORTH 00 DEGREES 25 MINUTES 48
SECONDS WEST 2645.79 FEET; THENCE ALONG THE WEST LINE OF THE NORTHEAST
QUARTER OF SAID SECTION 1 NORTH 89 DEGREES 40 MINUTES 00 SECONDS EAST

1253.64 FEET; THENCE SOUTH 45 DEGREES 19 MINUTES 01 SECONDS EAST 631.90 FEET; THENCE SOUTH 00 DEGREES 19 MINUTES 01 SECONDS EAST 1459.42 FEET; THENCE TO THE WEST BOUNDARY OF SAID CONDUIT NUMBER 27 PROPERTY NORTH 89 DEGREES 40 MINUTES 59 SECONDS EAST 778.00 FEET; THENCE ALONG SAID BOUNDARY SOUTH 00 DEGREES 19 MINUTES 01 SECONDS EAST 688.24 FEET TO THE POINT OF BEGINNING.

THIS DOCUMENT IS DERIVED FROM VARIOUS LEGAL DESCRIPTIONS AND WAS CHECKED AGAINST ASSESSOR'S MAPS, BUT DOES NOT CONSTITUTE A BOUNDARY SURVEY.

PARCEL 15 - LEGAL DESCRIPTION OF INCLUDED PROPERTY – PLUM VALLEY HEIGHTS INCLUSION (2013)

INCLUDING THEREFROM THE FOLLOWING DESCRIBED PROPERTY AS DESCRIBED IN THE INCLUSION AGREEMENT DATED MARCH 15, 2013.

LOT 1 BLK 3 PLUM VALLEY HEIGHTS SECOND FILING, COUNTY OF DOUGLAS, STATE OF COLORADO. ALSO KNOWN AS: 8312 W. TRAIL SOUTH DRIVE, LITTLETON, CO

LOT 3 BLK 2 PLUM VALLEY HEIGHTS FIRST FILING, COUNTY OF DOUGLAS, STATE OF COLORADO. ALSO KNOWN AS: 7652 TRAIL NORTH DRIVE, LITTLETON, CO

LOT 11 BLK 2 PLUM VALLEY HEIGHTS THIRD FILING, COUNTY OF DOUGLAS, STATE OF COLORADO. ALSO KNOWN AS: 7583 W. TRAIL SOUTH DRIVE, LITTLETON, CO

LOT 12 BLK 2 PLUM VALLEY HEIGHTS THIRD FILING, COUNTY OF DOUGLAS, STATE OF COLORADO. ALSO KNOWN AS: 7537 W. TRAIL SOUTH DRIVE, LITTLETON, CO

LOT 9 BLK 2 PLUM VALLEY HEIGHTS THIRD FILING, COUNTY OF DOUGLAS, STATE OF COLORADO. ALSO KNOWN AS: 7735 W. TRAIL SOUTH DRIVE, LITTLETON, CO

LOT 4 BLK 2 PLUM VALLEY HEIGHTS FIRST FILING, COUNTY OF DOUGLAS, STATE OF COLORADO. ALSO KNOWN AS: 7712 TRAIL NORTH DRIVE, LITTLETON, CO

LOT 5 BLK 1 PLUM VALLEY HEIGHTS SECOND FILING, COUNTY OF DOUGLAS, STATE OF COLORADO. ALSO KNOWN AS: 7779 TRAIL NORTH DRIVE, LITTLETON, CO

LOT 3 BLK 3 PLUM VALLEY HEIGHTS THIRD FILING, COUNTY OF DOUGLAS, STATE OF COLORADO. ALSO KNOWN AS: 8224 W. TRAIL SOUTH DRIVE, LITTLETON, CO

LOT 1 BLK 2 PLUM VALLEY HEIGHTS FIRST FILING, COUNTY OF DOUGLAS, STATE OF COLORADO. ALSO KNOWN AS: 7536 TRAIL NORTH DRIVE, LITTLETON, CO

LOT 3 BLK 1 PLUM VALLEY HEIGHTS FIRST FILING, COUNTY OF DOUGLAS, STATE OF COLORADO. ALSO KNOWN AS: 7651 TRAIL NORTH DRIVE, LITTLETON, CO

LOT 2 BLK 1 PLUM VALLEY HEIGHTS FIRST FILING, COUNTY OF DOUGLAS, STATE OF COLORADO. ALSO KNOWN AS: 7595 TRAIL NORTH DRIVE, LITTLETON, CO

LOT 2 BLK 3 PLUM VALLEY HEIGHTS SECOND FILING, COUNTY OF DOUGLAS, STATE OF COLORADO. ALSO KNOWN AS: 7964 TRAIL NORTH DRIVE, LITTLETON, CO

LOT 8 BLK 3 PLUM VALLEY HEIGHTS THIRD FILING, COUNTY OF DOUGLAS, STATE OF COLORADO. ALSO KNOWN AS: 7708 W. TRAIL SOUTH DRIVE, LITTLETON, CO

LOT 9 BLK 3 PLUM VALLEY HEIGHTS THIRD FILING, COUNTY OF DOUGLAS, STATE OF COLORADO. ALSO KNOWN AS: 7648 W. TRAIL SOUTH DRIVE, LITTLETON, CO

LOT 4 BLK 3 PLUM VALLEY HEIGHTS THIRD FILING, COUNTY OF DOUGLAS, STATE OF COLORADO. ALSO KNOWN AS: 8168 W. TRAIL SOUTH DRIVE, LITTLETON, CO

LOT 4 BLK 1 PLUM VALLEY HEIGHTS FIRST FILING, COUNTY OF DOUGLAS, STATE OF COLORADO. ALSO KNOWN AS: 7711 TRAIL NORTH DRIVE, LITTLETON, CO

LOT 7 BLK 3 PLUM VALLEY HEIGHTS THIRD FILING, COUNTY OF DOUGLAS, STATE OF COLORADO. ALSO KNOWN AS: 7774 W. TRAIL SOUTH DRIVE, LITTLETON, CO

LOT 6 BLK 3 PLUM VALLEY HEIGHTS THIRD FILING, COUNTY OF DOUGLAS, STATE OF COLORADO. ALSO KNOWN AS: 7832 W. TRAIL SOUTH DRIVE, LITTLETON, CO

LOT 5 BLK 3 PLUM VALLEY HEIGHTS THIRD FILING, COUNTY OF DOUGLAS, STATE OF COLORADO. ALSO KNOWN AS: 8116 W. TRAIL SOUTH DRIVE, LITTLETON, CO

LOT 5 BLK 2 PLUM VALLEY HEIGHTS SECOND FILING, COUNTY OF DOUGLAS, STATE OF COLORADO. ALSO KNOWN AS: 7812 TRAIL NORTH DRIVE, LITTLETON, CO

LOT 10 BLK 2 PLUM VALLEY HEIGHTS THIRD FILING, COUNTY OF DOUGLAS, STATE OF COLORADO. ALSO KNOWN AS: 7601 W. TRAIL SOUTH DRIVE, LITTLETON, CO

LOT 6 BLK 2 PLUM VALLEY HEIGHTS SECOND FILING, COUNTY OF DOUGLAS, STATE OF COLORADO. ALSO KNOWN AS: 8337 W. TRAIL SOUTH DRIVE, LITTLETON, CO

LOT 2 BLK 2 PLUM VALLEY HEIGHTS FIRST FILING, COUNTY OF DOUGLAS, STATE OF COLORADO. ALSO KNOWN AS: 7598 TRAIL NORTH DRIVE, LITTLETON, CO

LOT 1 BLK 1 PLUM VALLEY HEIGHTS FIRST FILING, COUNTY OF DOUGLAS, STATE OF COLORADO. ALSO KNOWN AS: 7535 TRAIL NORTH DRIVE, LITTLETON, CO

LOT 6 BLK 1 PLUM VALLEY HEIGHTS SECOND FILING, COUNTY OF DOUGLAS, STATE OF COLORADO. ALSO KNOWN AS: 7841 TRAIL NORTH DRIVE, LITTLETON, CO

LOT 8 BLK 1 PLUM VALLEY HEIGHTS SECOND FILING, COUNTY OF DOUGLAS, STATE OF COLORADO. ALSO KNOWN AS: 7965 TRAIL NORTH DRIVE, LITTLETON, CO

LOT 7 BLK 2 PLUM VALLEY HEIGHTS THIRD FILING, COUNTY OF DOUGLAS, STATE OF COLORADO. ALSO KNOWN AS: 8225 W. TRAIL SOUTH DRIVE, LITTLETON, CO

LOT 8 BLK 2 PLUM VALLEY HEIGHTS THIRD FILING, COUNTY OF DOUGLAS, STATE OF COLORADO. ALSO KNOWN AS: 8143 W. TRAIL SOUTH DRIVE, LITTLETON, CO

THIS DOCUMENT IS DERIVED FROM VARIOUS LEGAL DESCRIPTIONS AND WAS CHECKED AGAINST ASSESSOR'S MAPS, BUT DOES NOT CONSTITUTE A BOUNDARY SURVEY.