

WILLIAM P. ANKELE, JR.
JENNIFER GRUBER TANAKA
CLINT C. WALDRON
KRISTIN BOWERS TOMPKINS
ROBERT G. ROGERS
BLAIR M. DICKHONER
GEORGE M. ROWLEY



OF COUNSEL:
KRISTEN D. BEAR
K. SEAN ALLEN
TRISHA K. HARRIS
ZACHARY P. WHITE
HEATHER L. HARTUNG
MEGAN J. MURPHY

EVE M. G. VELASCO
AUDREY G. JOHNSON
CAREY S. SMITH V
ERIN K. STUTZ
JON L. WAGNER

December 20, 2021

**VIA ELECTRONIC SUBMISSION
AND ELECTRONIC MAIL**

Division of Local Government
E-filed via www.dola.colorado.gov/e-filing

Douglas County Clerk and Recorder
301 Wilcox Street
Castle Rock, CO 80104
recording@douglas.co.us

Douglas County Assessor
301 Wilcox Street
Castle Rock, CO 80104
assessors@douglas.co.us

**Re: Maher Ranch Metropolitan District No. 4 (LGID#:18092)
Map Filing Pursuant to §32-1-306, C.R.S. – No Change in Boundaries**

To Whom It May Concern:

Section 32-1-306, C.R.S., requires special districts to provide a current, accurate map of their boundaries to the Division of Local Government, County Clerk and Recorder and County Assessor by January 1 of each year. This letter is to inform you that the map that is currently on file with your office for the above-referenced District is the most current and accurate map. A copy of the current map is attached for your convenience.

Should you have any questions, please do not hesitate to contact me.

Sincerely,

WHITE BEAR ANKELE TANAKA & WALDRON
Attorneys at Law

Rose A. Vallesio, Paralegal

Enclosure

District Map

LGID#: 18092

Maher Ranch Metropolitan District #4 Authority # 4250

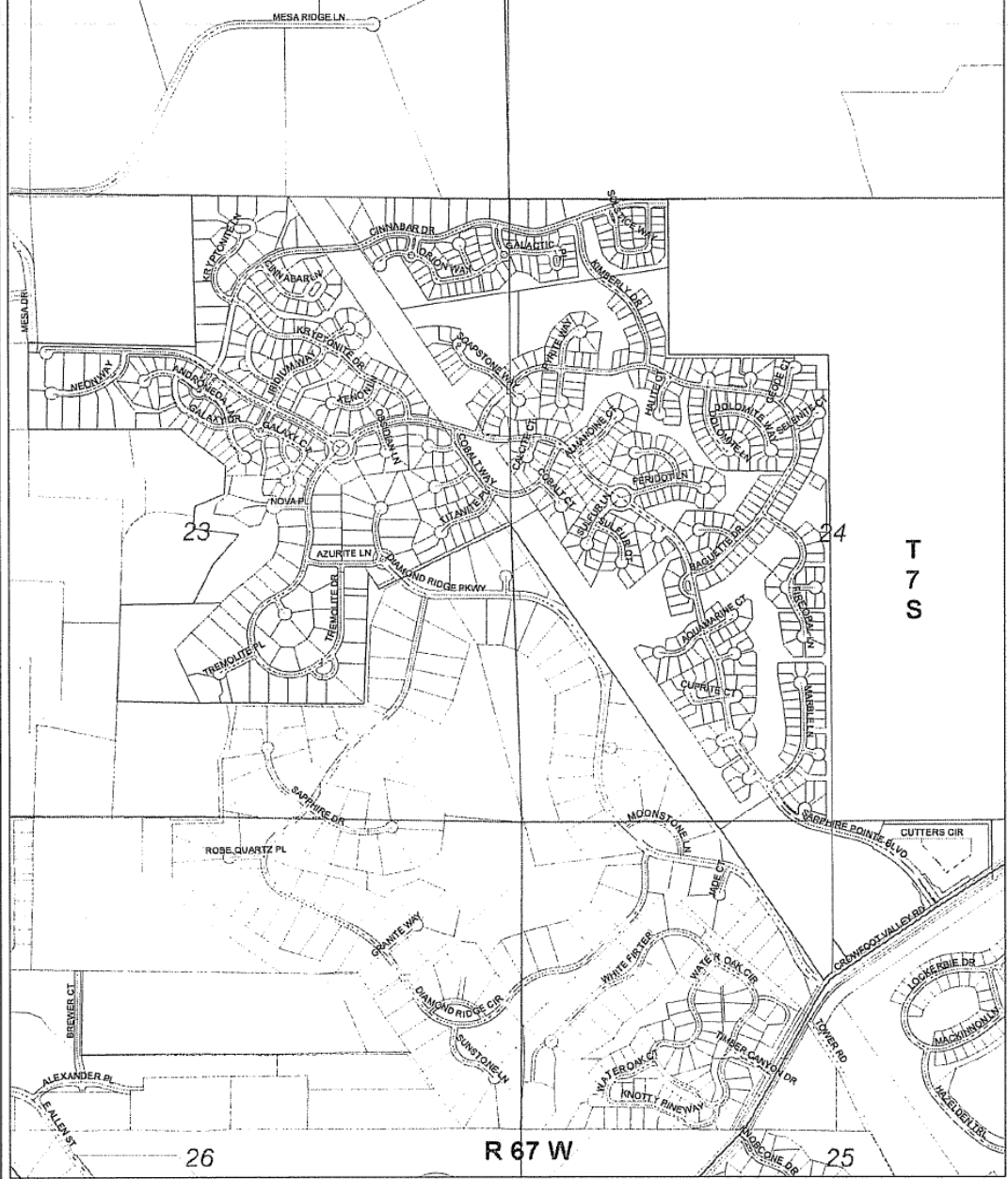
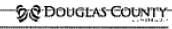

I, Blair Dickhoner, as representative of Maher Ranch MD No. 4 District, do hereby certify
 Name (printed) District name
 this map to be an accurate representation of the district's boundary as shown. Signed this 21st day of December, 2009.
Blair Dickhoner Signature bdickhoner@wbape.com Email
Attorney Title (303) 858-1800 Phone

DISCLAIMER
 All data and information ("Products") contained herein are for informational purposes only. Although Products are believed to be accurate at the time of printing, Douglas County does not warrant that such Products are error-free. Douglas County provides these Products on an "as is" basis without representation of any kind, express or implied, including, but not limited to, warranties of title, accuracy, completeness, or non-infringement. No liability is assumed for any errors or omissions, or for any damages arising out of the use of such Products, or the inability to use such Products as a result of any computer virus or other malware. The user acknowledges and agrees that the use of such Products is at the user's sole risk of loss.

General questions about this or any other Douglas County GIS product, including map information, can be made by contacting the Douglas County GIS Director at 303-863-1418.

Douglas County GIS Division
 P.O. Box 600000, Denver, CO 80260-0000
 1000 North Lincoln Avenue, Suite 1000, Denver, CO 80202

Legend
 — Maher Ranch Metropolitan District #4
 ▭ Parcels
 ▭ Sections
 ▭ Townships
 — Major Roads
 — Local Roads

Scale: 1:9,600
 1 inch equals 800 feet

Vicinity Map: Shows the location of the district within the surrounding area.