

GARY R. WHITE  
KRISTEN D. BEAR  
WILLIAM P. ANKELE, JR.  
JENNIFER GRUBER TANAKA\*  
CLINT C. WALDRON

**WHITE • BEAR • ANKELE**  
PROFESSIONAL CORPORATION  
ATTORNEYS AT LAW

K. SEAN ALLEN  
\*\*GEORGE M. ROWLEY  
NEIL RUTLEDGE  
\*\*\*ROBERT G. ROGERS  
BRENT E. BUTZIN  
KRISTIN J. BOWERS  
ZACHARY P. WHITE  
ABBY L. KIRKBRIDE

December 19, 2013

**VIA ELECTRONIC SUBMISSION  
AND ELECTRONIC MAIL:**

Division of Local Government  
1313 Sherman Street, Room 521  
Denver, Colorado 80203

**Re: Castleview Metropolitan District (LGID#:65799)  
2013 Map Filing**

Dear Sir or Madam,

Colorado Revised Statutes §32-1-306 requires special districts to provide a current, accurate map of their boundaries to the Division, Clerk and Recorder, and Assessor each year. This letter is to inform you that the map that is currently on file with your office for the above-reference district is the most current and accurate map. A copy of the map is enclosed for your convenience. If you have any questions please feel free to contact me.

Very truly yours,

WHITE, BEAR & ANKELE  
Professional Corporation

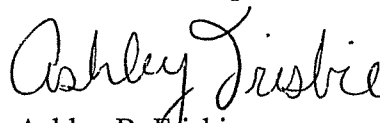
  
Ashley B. Frisbie  
Paralegal

Enclosure

cc: Douglas County Clerk & Recorder  
[jarrowsmith@douglas.co.us](mailto:jarrowsmith@douglas.co.us)

Douglas County Assessor  
[assessors@douglas.co.us](mailto:assessors@douglas.co.us)

0639.0024:551717

[www.whitebearankele.com](http://www.whitebearankele.com)  
2154 E. Commons Avenue, Suite 2000 • Centennial, CO 80122  
Telephone (303) 858-1800 • Facsimile (303) 858-1801  
*Also licensed in \*New Mexico, \*\*Utah, \*\*\*Texas*

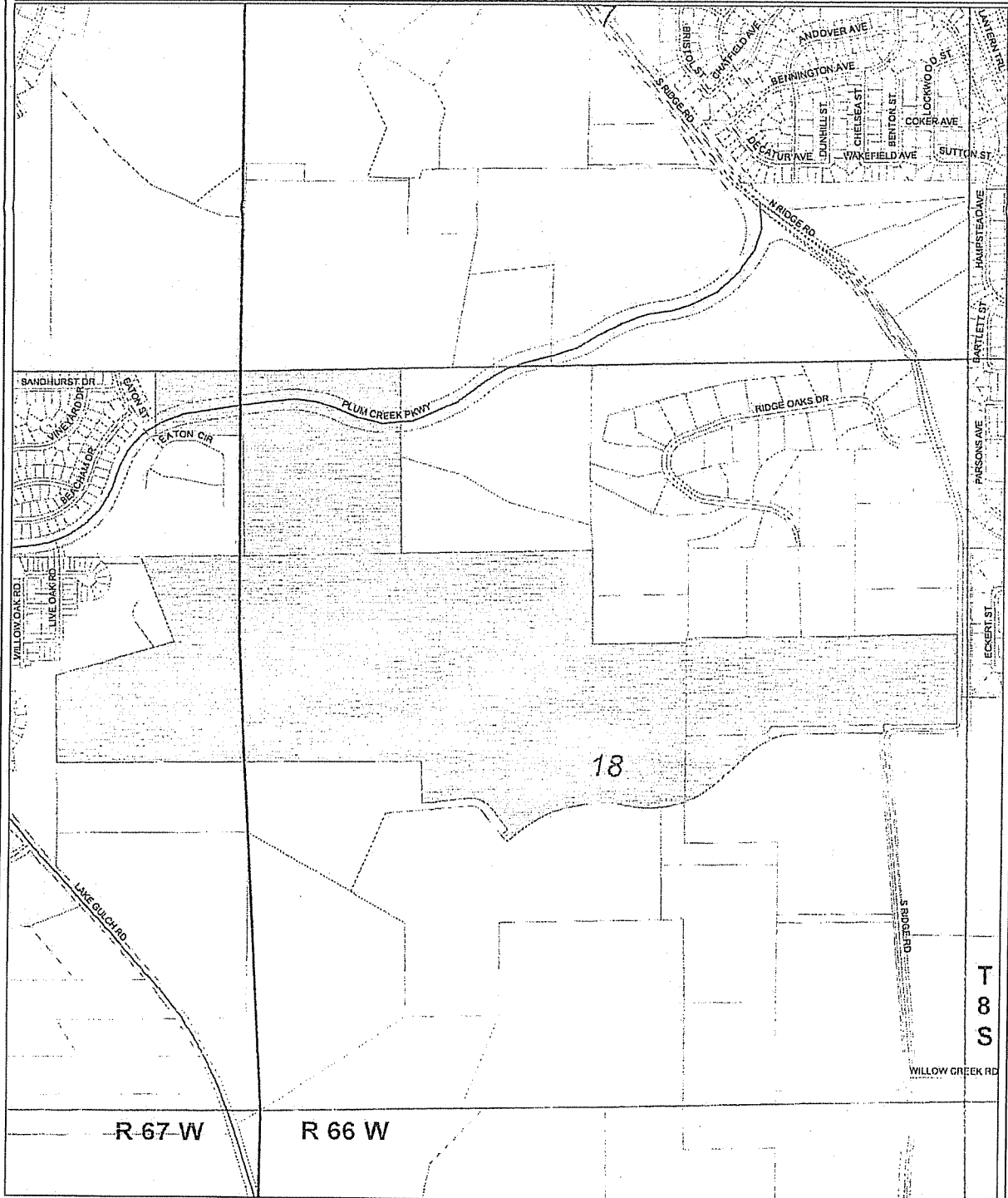

I, \_\_\_\_\_, as representative of \_\_\_\_\_ District, do hereby certify  
 Name (printed) District name

this map to be an accurate representation of the district's boundary as shown. Signed this \_\_\_\_\_ day of \_\_\_\_\_, 20\_\_\_\_.

Signature \_\_\_\_\_ Email \_\_\_\_\_  
 Title \_\_\_\_\_ Phone \_\_\_\_\_

DOUGLAS COUNTY  
 THE BOARD OF COUNTY COMMISSIONERS (BCC) created the Metropolitan District Authority (MDA) to provide water and sewer services to the residents of the County. The MDA is a public utility and is subject to the provisions of the Public Utility Code, Chapter 100, F.S. and the provisions of the Public Utility Regulation Act, Chapter 350, F.S. The MDA is a public utility and is subject to the provisions of the Public Utility Code, Chapter 100, F.S. and the provisions of the Public Utility Regulation Act, Chapter 350, F.S. The MDA is a public utility and is subject to the provisions of the Public Utility Code, Chapter 100, F.S. and the provisions of the Public Utility Regulation Act, Chapter 350, F.S.

- Legend**
- Castleview Metropolitan District
  - Parcels
  - Sections
  - Townships
  - Major Roads
  - Local Roads

