

December 18, 2013

**VIA ELECTRONIC SUBMISSION
AND ELECTRONIC MAIL:**

Division of Local Government
1313 Sherman Street, Room 521
Denver, Colorado 80203

**Re: The Canyons Metropolitan District No. 1 (LGID#: 65039)
2013 Map Filing**

Dear Sir or Madam,

Colorado Revised Statutes §32-1-306 requires special districts to provide a current, accurate map of their boundaries to the Division, Clerk and Recorder, and Assessor each year. This letter is to inform you that the map that is currently on file with your office for the above-referenced district is the most current and accurate map. A copy of the map is enclosed for your convenience. If you have any questions, please feel free to contact me.

Very truly yours,

WHITE, BEAR & ANKELE
Professional Corporation

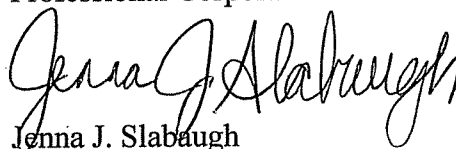

Jenna J. Slabaugh
Paralegal

Enclosure

cc: Douglas County Clerk & Recorder
elections@douglas.co.us

Douglas County Assessor
assessors@douglas.co.us

EXHIBIT

THE CANYONS METROPOLITAN DISTRICTS No. 1

TOWNSHIP 6 SOUTH, RANGE 67 WEST

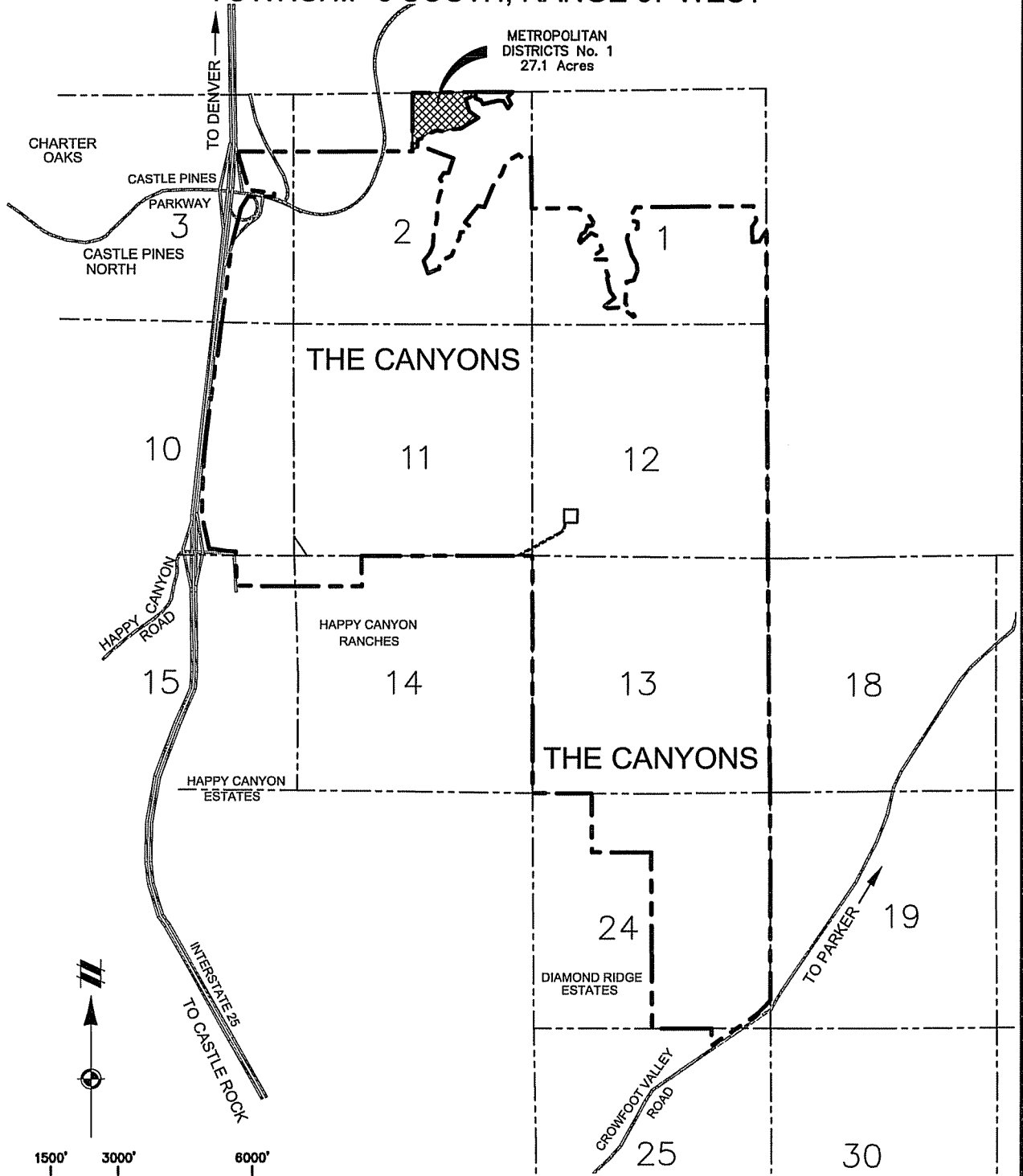

1 inch = 3000 ft.



ATWELL
INCORPORATED | www.atwellgroup.com
OFFICES IN NORTH AMERICA AND ASIA
3015 E. FIRST AVENUE
DENVER, CO 80202
303 825 7100