



Jenna J. Slabaugh  
Paralegal

303-858-1800  
jslabaugh@wbapc.com

December 17, 2024

**VIA ELECTRONIC SUBMISSION  
AND ELECTRONIC MAIL**

Division of Local Government  
*E-filed via [www.dola.colorado.gov/e-filing](http://www.dola.colorado.gov/e-filing)*

Douglas County Clerk and Recorder  
301 Wilcox Street  
Castle Rock, CO 80104  
clerk@douglas.co.us

Douglas County Assessor  
301 Wilcox Street  
Castle Rock, CO 80104  
assessors@douglas.co.us

**Re: The Canyons Metropolitan District No. 5 (LGID#:66225)  
Map Filing Pursuant to §32-1-306, C.R.S. – No Change in Boundaries**

To Whom It May Concern:

Section 32-1-306, C.R.S., requires special districts to provide a current, accurate map of their boundaries to the Division of Local Government, County Clerk and Recorder and County Assessor by January 1 of each year. This letter is to inform you that the map that is currently on file with your office for the above-referenced District is the most current and accurate map. A copy of the current map is attached for your convenience.

Should you have any questions, please do not hesitate to contact me.

Sincerely,

WHITE BEAR ANKELE TANAKA & WALDRON  
Attorneys at Law

Jenna J. Slabaugh, Paralegal

Enclosure

# EXHIBIT

## THE CANYONS METROPOLITAN DISTRICT NO. 5

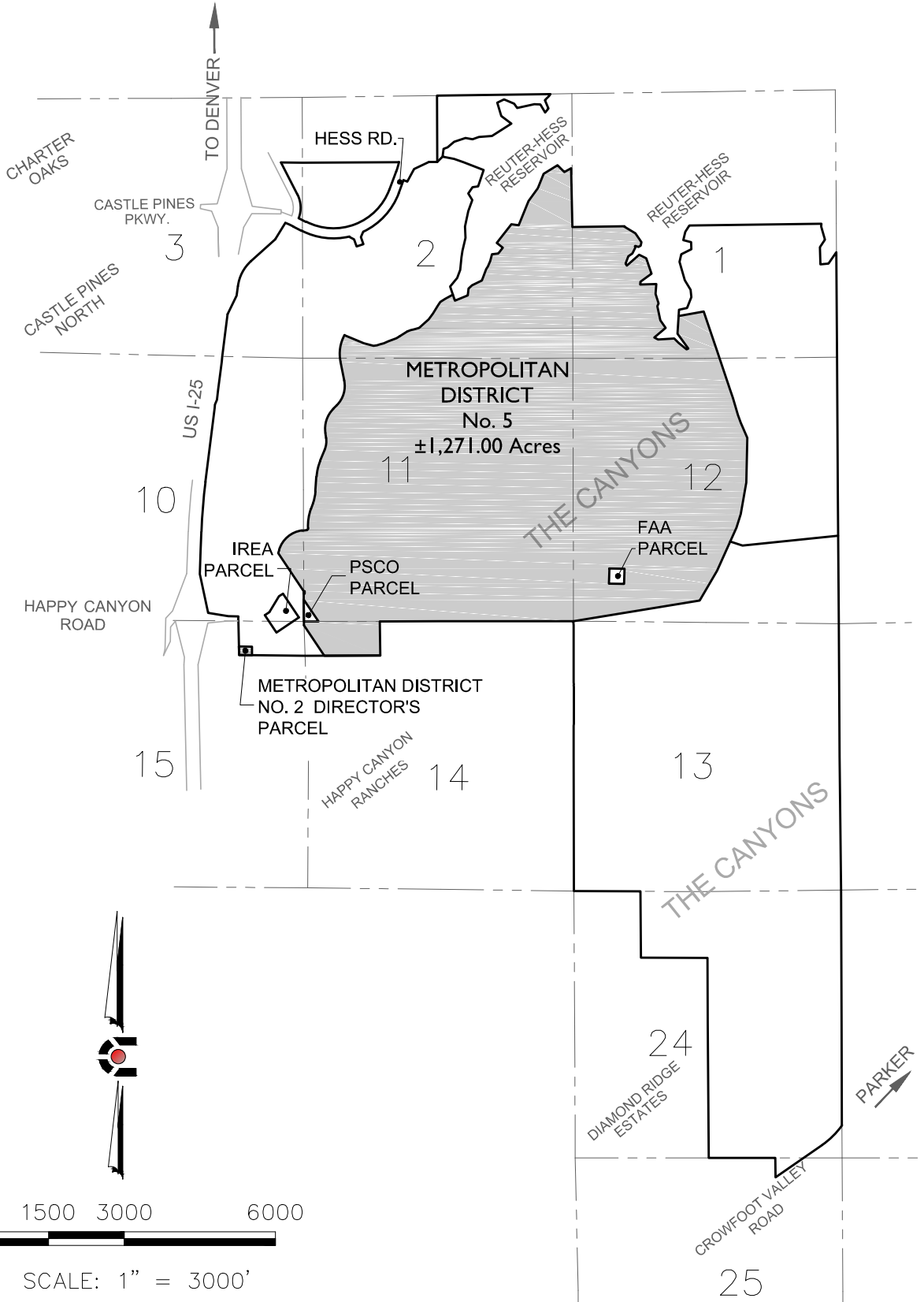

0 1500 3000 6000

SCALE: 1" = 3000'

NOTE: THIS DOES NOT REPRESENT A MONUMENTED SURVEY.  
 IT IS INTENDED ONLY TO DEPICT THE ATTACHED DESCRIPTION.  
 PROJECT: 14-002  
 DATE: 12/16/15  
 SHEET 3 OF 3

DR: J. ANTON  
 DS: T. GIRARD  
 P.M. B. CALVERT



**CORE**  
 CONSULTANTS

CIVIL ENGINEERING  
 DEVELOPMENT CONSULTING  
 NATURAL RESOURCES  
 LAND SURVEYING  
 303.703.4444  
 1950 W. Littleton Blvd., Sta. 109  
 Littleton, CO 80120