



Jenna J. Slabaugh
Paralegal

303-858-1800
jslabaugh@wbapc.com

December 11, 2023

**VIA ELECTRONIC SUBMISSION
AND ELECTRONIC MAIL**

Division of Local Government
E-filed via www.dola.colorado.gov/e-filing

Douglas County Clerk and Recorder
301 Wilcox Street
Castle Rock, CO 80104
recording@douglas.co.us

Douglas County Assessor
301 Wilcox Street
Castle Rock, CO 80104
assessors@douglas.co.us

**Re: The Canyons Metropolitan District No. 6 (LGID#:66226)
Map Filing Pursuant to §32-1-306, C.R.S. – No Change in Boundaries**

To Whom It May Concern:

Section 32-1-306, C.R.S., requires special districts to provide a current, accurate map of their boundaries to the Division of Local Government, County Clerk and Recorder and County Assessor by January 1 of each year. This letter is to inform you that the map that is currently on file with your office for the above-referenced District is the most current and accurate map. A copy of the current map is attached for your convenience.

Should you have any questions, please do not hesitate to contact me.

Sincerely,

WHITE BEAR ANKELE TANAKA & WALDRON
Attorneys at Law

Jenna J. Slabaugh, Paralegal

Enclosure

EXHIBIT

THE CANYONS METROPOLITAN DISTRICT NO. 6
PORTIONS OF SECTIONS 1, 2, 10, 11, 12 AND 14,
TOWNSHIP 7 SOUTH, RANGE 67 WEST OF THE 6TH P.M.,
DOUGLAS COUNTY, COLORADO

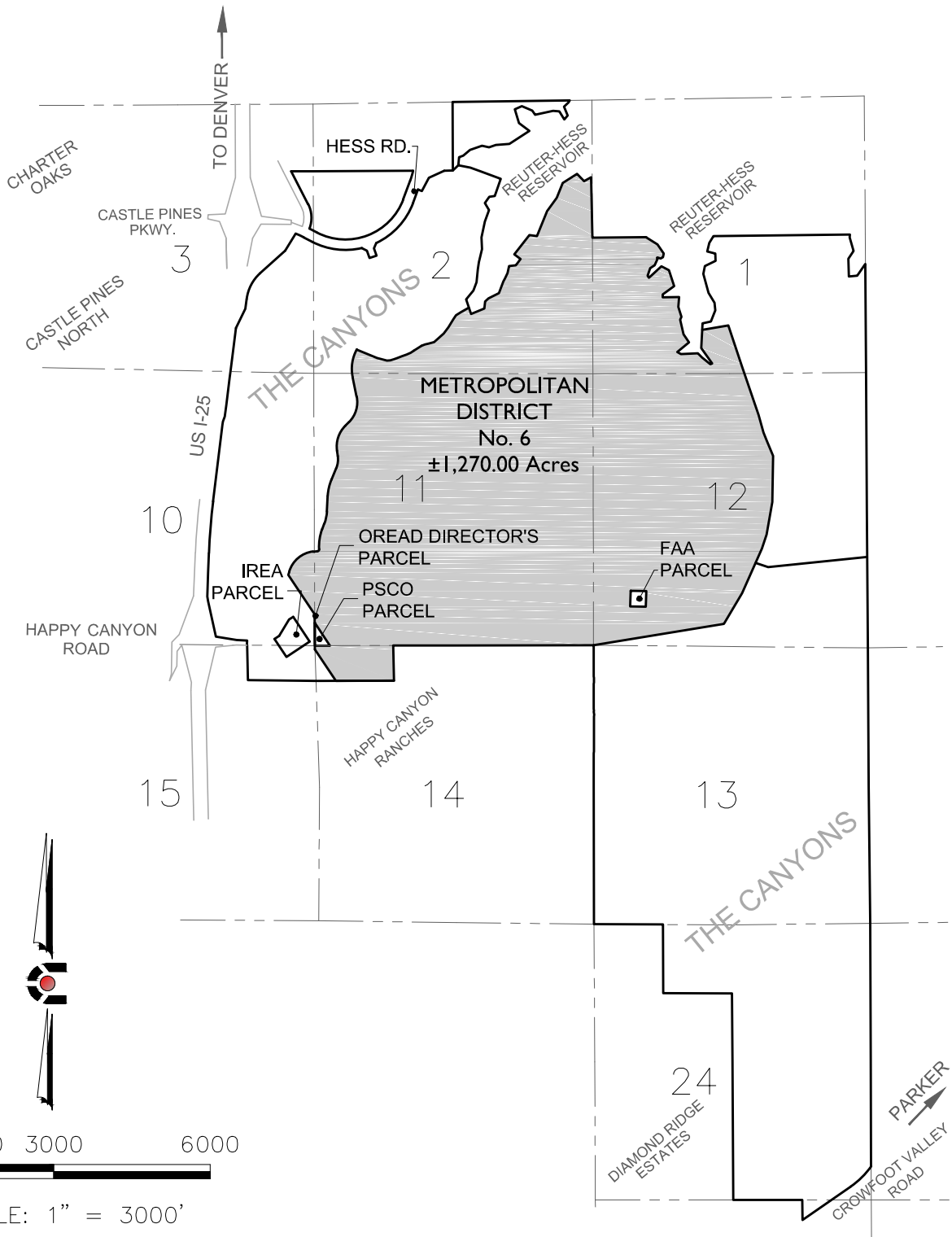

NOTE: THIS DOES NOT REPRESENT A MONUMENTED SURVEY.
IT IS INTENDED ONLY TO DEPICT THE ATTACHED DESCRIPTION.
PROJECT: 14-002
DATE: 12/30/15
SHEET 8 OF 8

DR: J. ANTON
DS: T. GIRARD
P.M. B. CALVERT



CORE
CONSULTANTS

CIVIL ENGINEERING
DEVELOPMENT CONSULTING
NATURAL RESOURCES
LAND SURVEYING
303.703.4444
1950 W. Littleton Blvd., Ste. 109
Littleton, CO 80120