

WILLIAM P. ANKELE, JR.
JENNIFER GRUBER TANAKA
CLINT C. WALDRON
KRISTIN BOWERS TOMPKINS
ROBERT G. ROGERS
BLAIR M. DICKHONER

OF COUNSEL:
KRISTEN D. BEAR
K. SEAN ALLEN
GEORGE M. ROWLEY



ZACHARY P. WHITE
TRISHA K. HARRIS
HEATHER L. HARTUNG
MEGAN J. MURPHY
EVE M. GRINA
ALLISON C. FOGG
JENNIFER C. ROGERS
LAURA S. HEINRICH
CHRISTOPHER T. MCMICHAEL
AUDREY G. JOHNSON

December 18, 2019

**VIA ELECTRONIC SUBMISSION
AND ELECTRONIC MAIL**

Division of Local Government
E-filed via www.dola.colorado.gov/e-filing

Douglas County Clerk and Recorder
301 Wilcox Street
Castle Rock, CO 80104
recording@douglas.co.us

Douglas County Assessor
301 Wilcox Street
Castle Rock, CO 80104
assessors@douglas.co.us

**Re: The Canyons Metropolitan District No. 6 (LGID#:66226)
Map Filing Pursuant to §32-1-306, C.R.S. – No Change in Boundaries**

To Whom It May Concern:

Section 32-1-306, C.R.S., requires special districts to provide a current, accurate map of their boundaries to the Division of Local Government (the “Division”), County Clerk and Recorder and County Assessor by January 1 of each year. This letter is to inform you that the map that is currently on file with your office for the above-referenced District is the most current and accurate map. A copy of the current map is attached for your convenience.

Should you have any questions, please do not hesitate to contact me.

Sincerely,

WHITE BEAR ANKELE TANAKA & WALDRON
Attorneys at Law

Allison L. Hanson, Senior Paralegal

Attachment
1427.0024; 1012797

EXHIBIT

THE CANYONS METROPOLITAN DISTRICT NO. 6
 PORTIONS OF SECTIONS 1, 2, 10, 11, 12 AND 14,
 TOWNSHIP 7 SOUTH, RANGE 67 WEST OF THE 6TH P.M.,
 DOUGLAS COUNTY, COLORADO

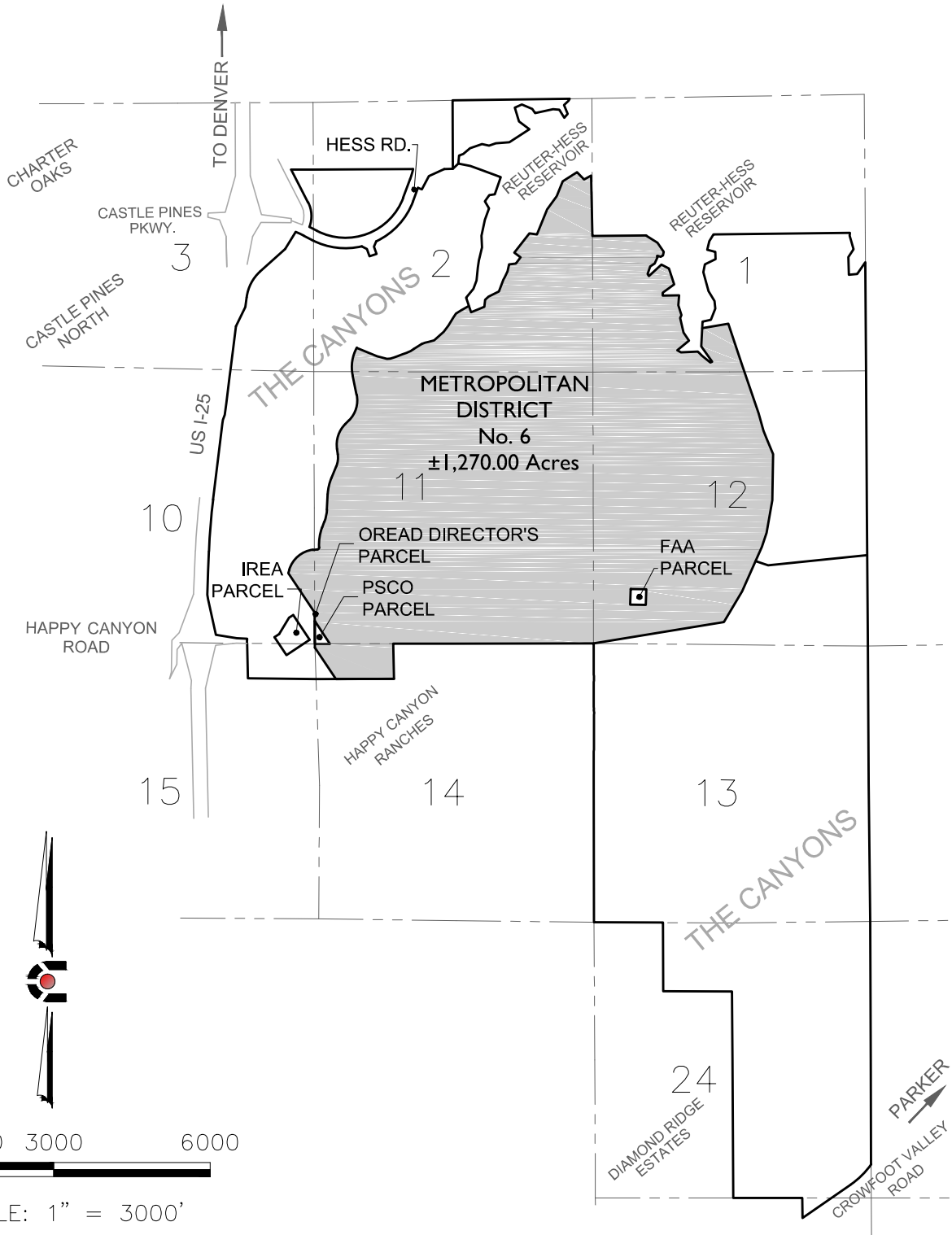

NOTE: THIS DOES NOT REPRESENT A MONUMENTED SURVEY.
 IT IS INTENDED ONLY TO DEPICT THE ATTACHED DESCRIPTION.
 PROJECT: 14-002
 DATE: 12/30/15
 SHEET 8 OF 8

DR: J. ANTON
 DS: T. GIRARD
 P.M. B. CALVERT



CORE
 CONSULTANTS

CIVIL ENGINEERING
 DEVELOPMENT CONSULTING
 NATURAL RESOURCES
 LAND SURVEYING
 303.703.4444
 1950 W. Littleton Blvd., Ste. 109
 Littleton, CO 80120