

WILLIAM P. ANKELE, JR.  
JENNIFER GRUBER TANAKA  
CLINT C. WALDRON  
KRISTIN BOWERS TOMPKINS  
ROBERT G. ROGERS

OF COUNSEL:  
KRISTEN D. BEAR  
BLAIR M. DICKHONER



SEAN ALLEN  
ZACHARY P. WHITE  
CASEY K. LEKAHAL  
TRISHA K. HARRIS  
HEATHER L. HARTUNG  
MEGAN J. MURPHY  
EVE M. GRINA  
JENNIFER F. KEMP  
ALLISON C. FOGG

December 28, 2018

**VIA ELECTRONIC SUBMISSION  
AND ELECTRONIC MAIL**

Division of Local Government

Douglas County Clerk & Recorder  
[Recording@douglas.co.us](mailto:Recording@douglas.co.us)

Douglas County Assessor  
[assessors@douglas.co.us](mailto:assessors@douglas.co.us)

**Re: The Canyons Metropolitan District No. 7 (LGID#: 66227)  
Map Filing Pursuant to §32-1-306, C.R.S. – No Change in Boundaries**

To Whom It May Concern:

Section 32-1-306, C.R.S., requires special districts to provide a current, accurate map of their boundaries to the Division of Local Government (the “Division”), County Clerk and Recorder and County Assessor by January 1 of each year. This letter is to inform you that the map that is currently on file with your office for the above-referenced District is the most current and accurate map. A copy of the current map is attached for your convenience.

Should you have any questions, please do not hesitate to contact me.

Sincerely,

WHITE BEAR ANKELE TANAKA & WALDRON  
Attorneys at Law

Rose A. Vallesio  
Paralegal

Attachment

# EXHIBIT

## THE CANYONS METROPOLITAN DISTRICT NO. 7

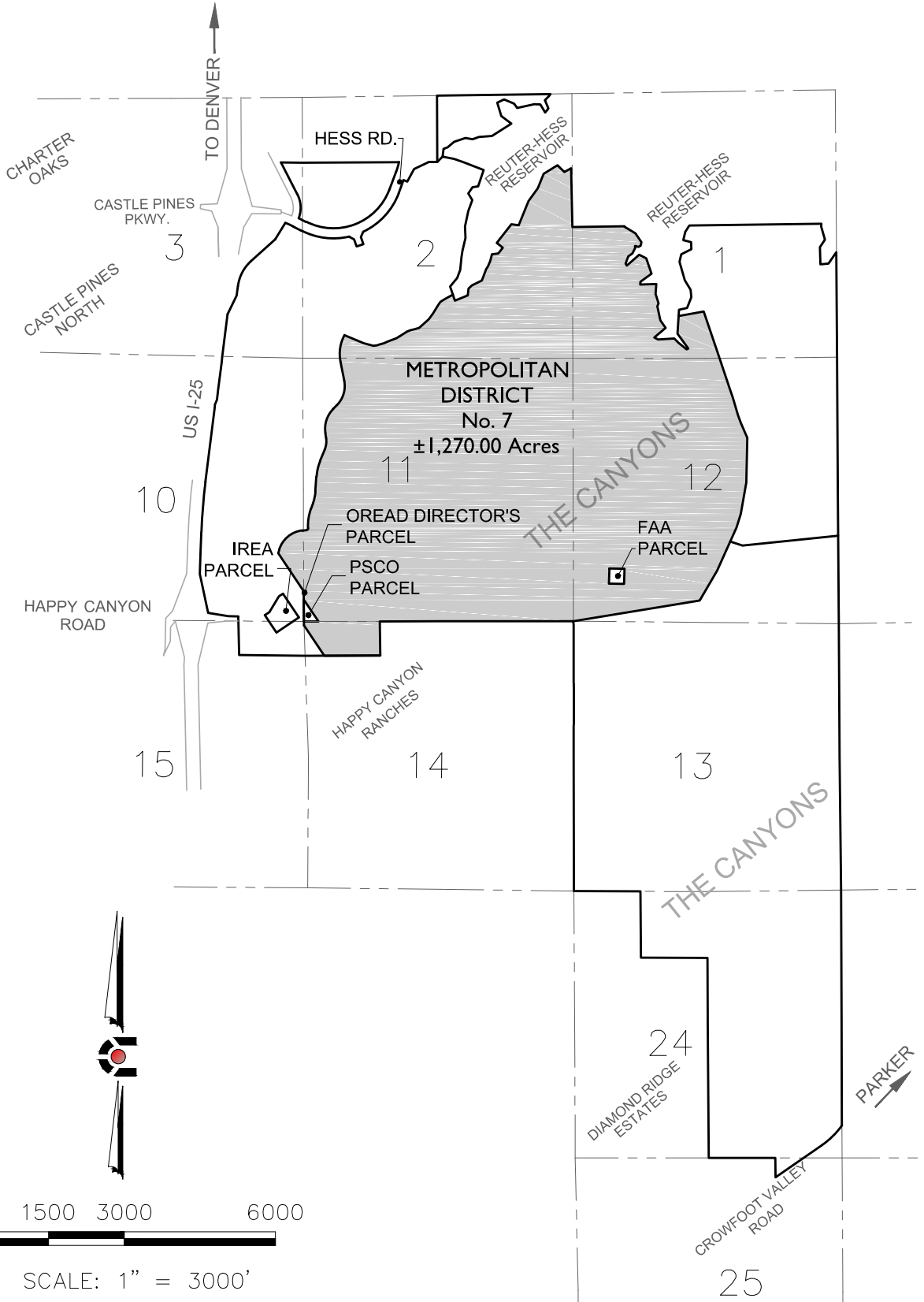

NOTE: THIS DOES NOT REPRESENT A MONUMENTED SURVEY.  
 IT IS INTENDED ONLY TO DEPICT THE ATTACHED DESCRIPTION.  
 PROJECT: 14-002  
 DATE: 12/16/15  
 SHEET 3 OF 3

DR: J. ANTON  
 DS: T. GIRARD  
 P.M. B. CALVERT



**CORE**  
**CONSULTANTS**

**CIVIL ENGINEERING  
 DEVELOPMENT CONSULTING  
 NATURAL RESOURCES  
 LAND SURVEYING**  
 303.703.4444  
 1950 W. Littleton Blvd., Ste. 109  
 Littleton, CO 80120