

GARY R. WHITE  
KRISTEN D. BEAR  
WILLIAM P. ANKELE, JR.  
JENNIFER GRUBER TANAKA  
CLINT C. WALDRON  
KRISTIN BOWERS TOMPKINS  
ROBERT G. ROGERS



SEAN ALLEN  
GEORGE M. ROWLEY  
NEIL RUTLEDGE  
ZACHARY P. WHITE  
MEGAN L. TAGGART  
MATTHEW T. ASHLEY  
CASEY K. LEKAHAL  
TRISHA K. HARRIS

December 30, 2015

**VIA ELECTRONIC SUBMISSION  
AND ELECTRONIC MAIL**

Division of Local Government

Douglas County Clerk & Recorder  
[recording@douglas.co.us](mailto:recording@douglas.co.us)  
[elections@douglas.co.us](mailto:elections@douglas.co.us)

Douglas County Assessor  
[assessors@douglas.co.us](mailto:assessors@douglas.co.us)

**Re: The Canyons Metropolitan District No. 5 (LGID#: 66225)  
Map Filing Pursuant to §32-1-306, C.R.S. – Change in Boundaries**

To Whom It May Concern:

Section 32-1-306, C.R.S., requires special districts to provide a current, accurate map of their boundaries to the Division of Local Government (the “Division”), County Clerk and Recorder and County Assessor by January 1 of each year. A copy of the updated map for the above-referenced District was electronically submitted on the Division’s website and is also enclosed for your convenience.

Should you have any questions, please do not hesitate to contact me.

Sincerely,

WHITE BEAR ANKELE TANAKA & WALDRON  
Attorneys at Law

Nadia R. Hernandez  
Paralegal

Attachment

# EXHIBIT

## THE CANYONS METROPOLITAN DISTRICT NO. 5

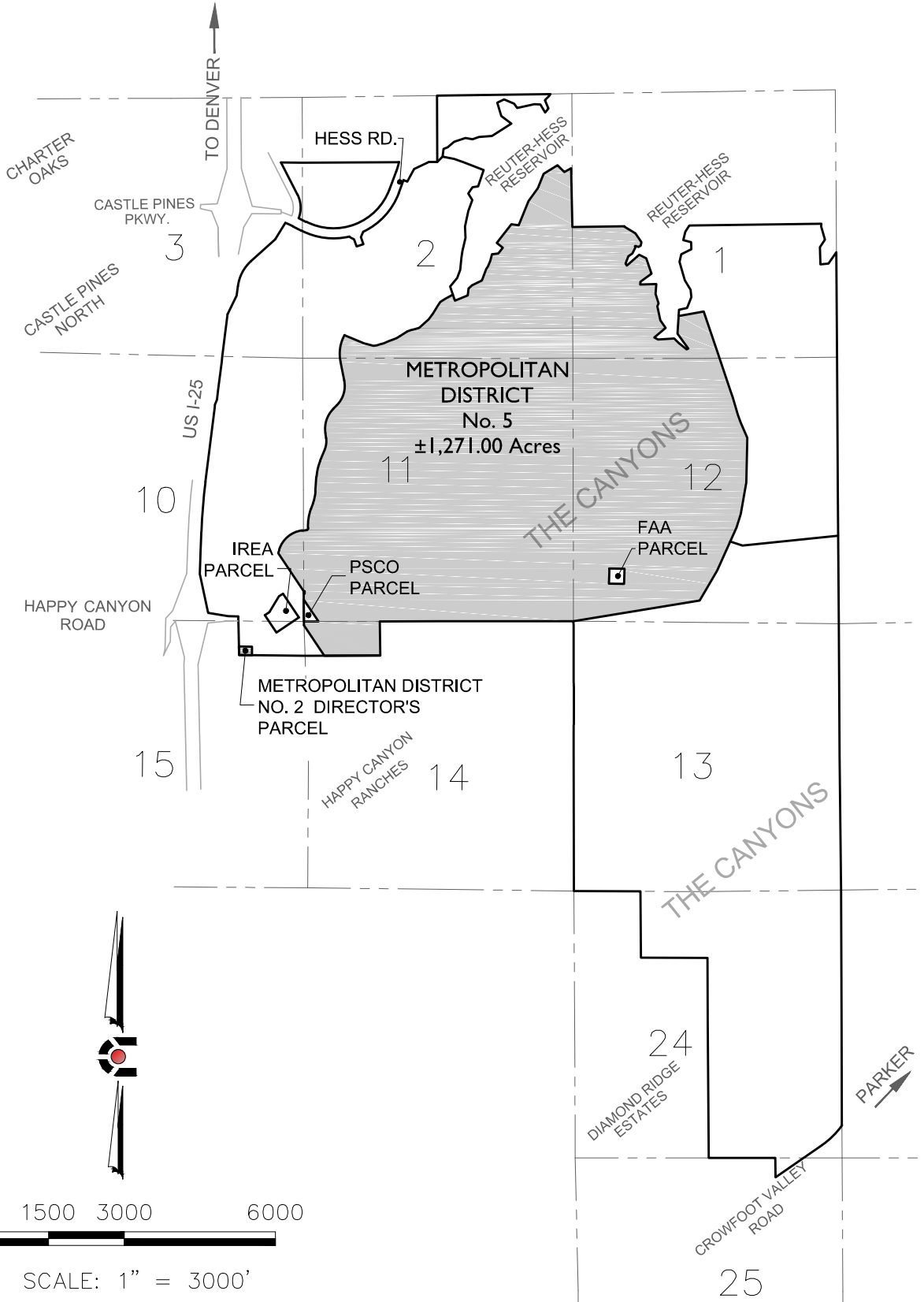

NOTE: THIS DOES NOT REPRESENT A MONUMENTED SURVEY.  
 IT IS INTENDED ONLY TO DEPICT THE ATTACHED DESCRIPTION.  
 PROJECT: 14-002  
 DATE: 12/16/15  
 SHEET 3 OF 3

DR: J. ANTON  
 DS: T. GIRARD  
 P.M. B. CALVERT



**CORE**  
**CONSULTANTS**

CIVIL ENGINEERING  
 DEVELOPMENT CONSULTING  
 NATURAL RESOURCES  
 LAND SURVEYING  
 303.703.4444  
 1950 W. Littleton Blvd., Sta. 109  
 Littleton, CO 80120