

GARY R. WHITE
KRISTEN D. BEAR
WILLIAM P. ANKELE, JR.
JENNIFER GRUBER TANAKA
CLINT C. WALDRON
KRISTIN BOWERS TOMPKINS
ROBERT G. ROGERS



SEAN ALLEN
GEORGE M. ROWLEY
NEIL RUTLEDGE
ZACHARY P. WHITE
MEGAN L. TAGGART
MATTHEW T. ASHLEY
CASEY K. LEKAHAL
TRISHA K. HARRIS

December 30, 2015

**VIA ELECTRONIC SUBMISSION
AND ELECTRONIC MAIL**

Division of Local Government

Douglas County Clerk & Recorder
recording@douglas.co.us
elections@douglas.co.us

Douglas County Assessor
assessors@douglas.co.us

**Re: The Canyons Metropolitan District No. 2 (LGID#: 65040)
Map Filing Pursuant to §32-1-306, C.R.S. – Change in Boundaries**

To Whom It May Concern:

Section 32-1-306, C.R.S., requires special districts to provide a current, accurate map of their boundaries to the Division of Local Government (the “Division”), County Clerk and Recorder and County Assessor by January 1 of each year. A copy of the updated map for the above-referenced District was electronically submitted on the Division’s website and is also enclosed for your convenience.

Should you have any questions, please do not hesitate to contact me.

Sincerely,

WHITE BEAR ANKELE TANAKA & WALDRON
Attorneys at Law

Nadia R. Hernandez
Paralegal

Attachment

EXHIBIT

THE CANYONS METROPOLITAN DISTRICT NO.2
PORTIONS OF SECTIONS 1, 2, 3, 10, 11, 12, 14 AND 15,
TOWNSHIP 7 SOUTH, RANGE 67 WEST OF THE 6TH P.M.,
DOUGLAS COUNTY, COLORADO

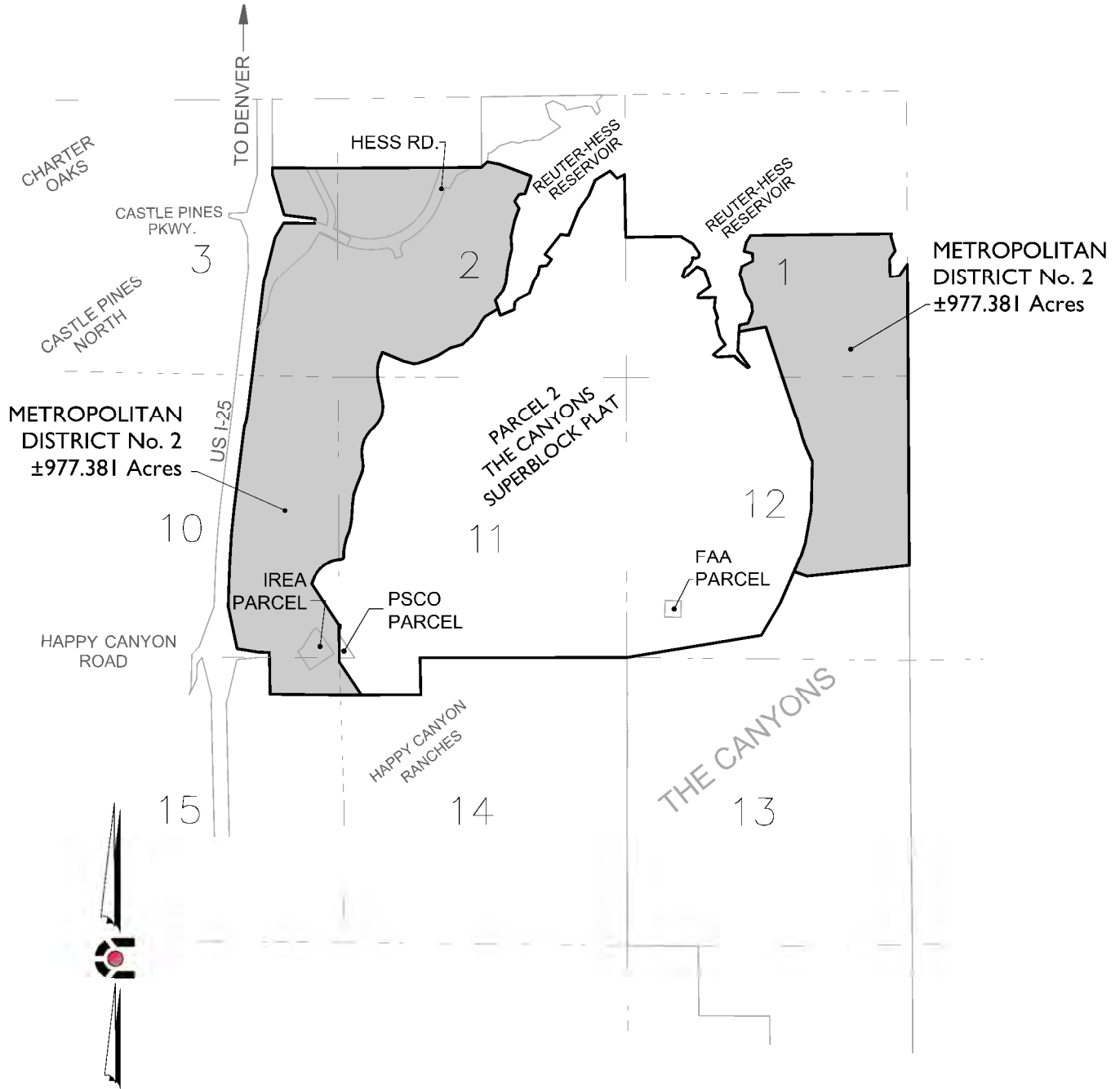

SCALE: 1" = 3000'

NOTE: THIS DOES NOT REPRESENT A MONUMENTED SURVEY.
IT IS INTENDED ONLY TO DEPICT THE ATTACHED DESCRIPTION.
PROJECT: 14-002 DR: J. ANTON
DATE: 12/24/15 DS: T. GIRARD
SHEET 1 OF 2 P.M. B. CALVERT



CORE
CONSULTANTS

CIVIL ENGINEERING
DEVELOPMENT CONSULTING
NATURAL RESOURCES
LAND SURVEYING
303.703.4444
1950 W. Littleton Blvd., Ste. 109
Littleton, CO 80120